

[034Motorsport Dynamic+ Rear End Link Kit, MQB](#)

**034 MOTOR SPORT**

034Motorsport's Dynamic+ Rear End Links for the MQB chassis are the new standard in performance and durability. These end links were engineered with performance, and more importantly, strength and longevity, in mind. Manufactured from 304 stainless and zinc plated steel, for strength and long lasting reliability.

Installation Spiciness Rating



(Mild)

Installation of your 034Motorsport Dynamic+ Rear End Links is a straightforward process that will take approximately 30 minutes to complete.

Supplied Parts:

- (2x) 034Motorsport Dynamic+ Rear End Links

Tools Needed:

- 6mm Triple Square
- 5mm Allen
- 13mm wrenches
- 16mm Wrenches
- 17mm Wrenches
- Torque Wrench

About This Guide

This Install Guide documents the installation process on a 2016 Audi S3 and 2018 Audi RS3. There may be minor differences on other vehicles, depending on specific vehicle, market, options, etc.

Getting Started

- Ensure you have all parts and tools required for installation by reading the complete Install Guide.

Step 1

Raise the vehicle securely on jackstands or a lift, in order to gain access to the rear suspension. Make sure you have all tools necessary for installation of the MQB Spherical Rear Sway Bar End Links. Locate the factory rear end links.



Step 2

Using two 13mm wrenches, remove the bolt and nut securing the bottom of the end link to the lower control arm. Using a 16mm wrench and 6mm triple square, remove the nut securing the upper end link to the rear sway bar.



Step 3

Determine which setting you will be using on the sway bar, and adjust the end link spacer orientation accordingly.

Upper link orientation should be rotated 90 degrees from lower link.

Lock links in position by holding upper link with a 17mm wrench, and tightening the jamb nut with a 19mm wrench.

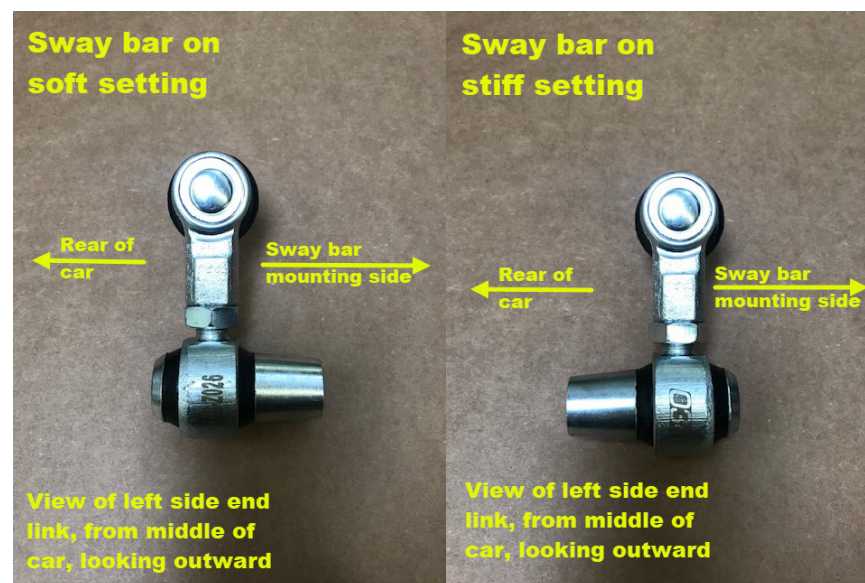

Step 4

Install the 034Motorsport Dynamic+ End Link into the lower control arm. Secure using the factory bolt and supplied M8 lock nut. Torque to 35 Nm.



Step 5

With a 17mm wrench and 5mm Allen, secure the top of the end link to the rear sway bar using the supplied M10 nut and washer. Torque to 45 Nm.

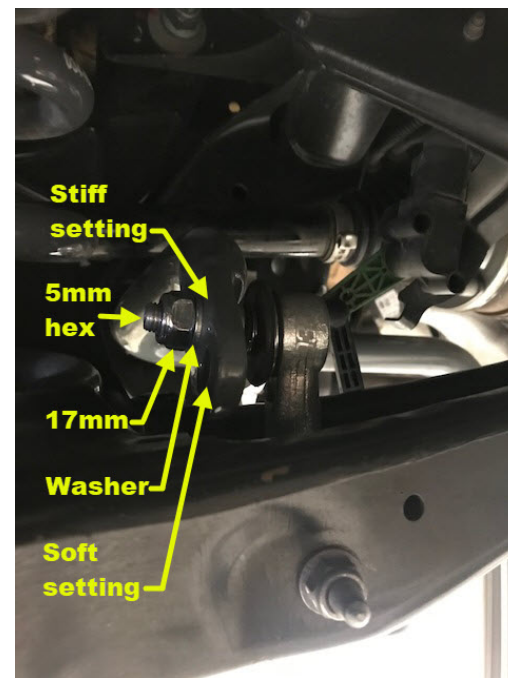

Step 6

Repeat Steps 2-5 for the other side.

Step 7

Enjoy!