

**Toggle Button Kit**  
**Installation Instructions**  
MK5 / MK6 Golf, MK5 Jetta



Thank you for choosing the Double Apex Toggle Button kit. If you have any questions about the installation please do not hesitate to email us at [support@doubleapex.co](mailto:support@doubleapex.co). A PDF copy of this document can be found on the product page at [doubleapex.co](http://doubleapex.co)

**Parts Included:**

A - Button

B - Button harness

C - Relay module

D - Posi-Taps (x2)

E - T20 Torx key

F - 3mm Allen key

G - 1/16" Allen key

H - Small screwdriver

I - Add-A-Fuse

J - 10 amp fuse

K - Zip ties

L - Relay case screws

M - Ground wire



### Step 1:

- A. Remove the driver side fuse panel cover and the fuse panel screw (at arrow) with a T20 Torx bit.
- B. Remove the T20 Torx screws holding the under dash cover and knee bolster (yellow arrows).
- C. Remove the headlight switch by pushing in the knob and turning to the right to release. Remove the T20 Torx screw behind the switch.
- D. Pull out the trim piece above the steering column and remove the T20 Torx on the left side.
- E. Remove the knee bolster and disconnect the dimmer switch. Pull out to release the lower retaining clip (blue arrow, fig. B) Remove the under dash cover.

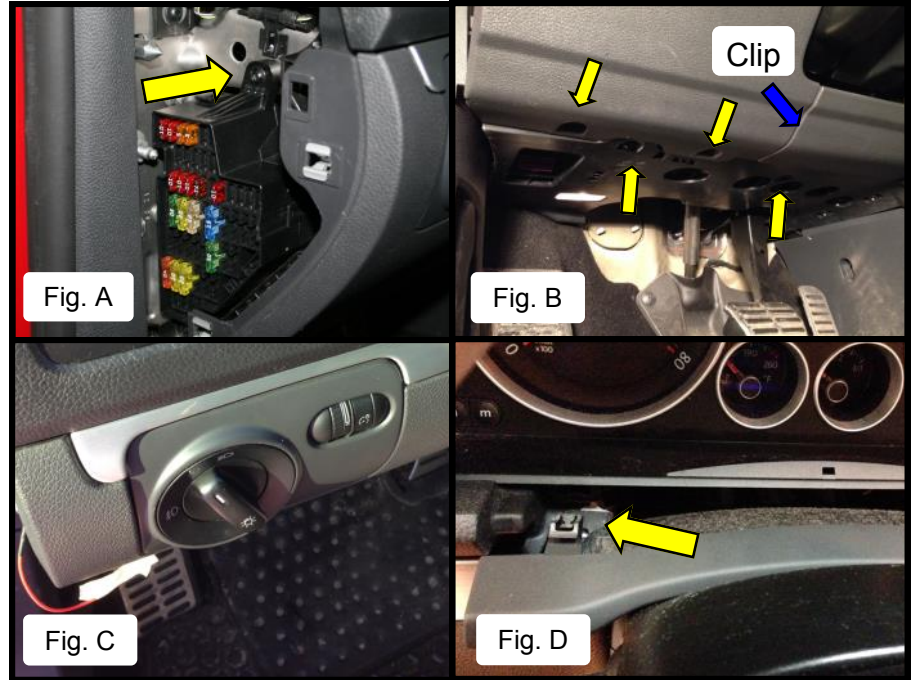

## Step 2:

- A. Move the shift lever to the rearmost position. Use a plastic trim removal tool to detach the trim surrounding the shifter (arrow). It may also be possible to grasp the edges of the trim surrounding the shifter, where it meets the shift boot, and pull straight up to detach. Pull it up and out of the way to expose the Torx screws below.
- B. Remove the T20 Torx screws at the front of the button cluster. Be careful not to let the screws fall into the shifter recess. Set the screws aside in a safe place.

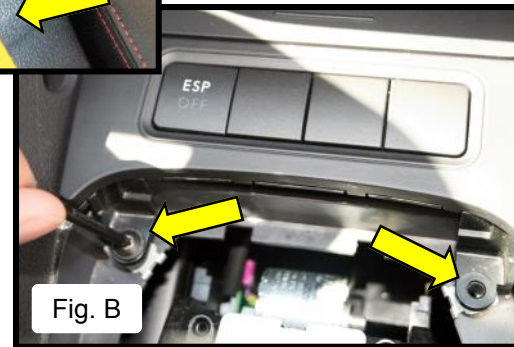

### Step 3:

Lift up the front of the button cluster enough to expose the connectors below. **Disconnect the negative battery terminal. Make sure the key is in the off position.**

- A. Disconnect the ESP and any other button harnesses by depressing the tab on the left side of the connector and pulling downward. **Put some downward pressure on the button top while doing so to prevent it from moving upward and possibly dislodging its retaining clips.**
- B. Detach the harness support if equipped. You may want to pry it loose with a small flat head screw driver.
- C. Disconnect the 12v power socket by depressing the tab on the connector and pulling downward. On models with the socket on the left, the tab is on the back side.
- D. If equipped disconnect the audio input connector by depressing the tab, circled in yellow, with a small screw driver.

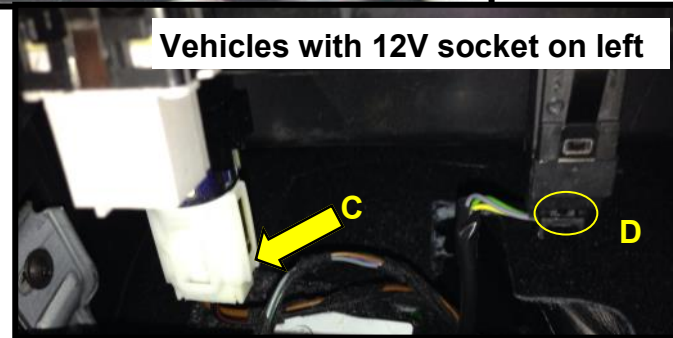
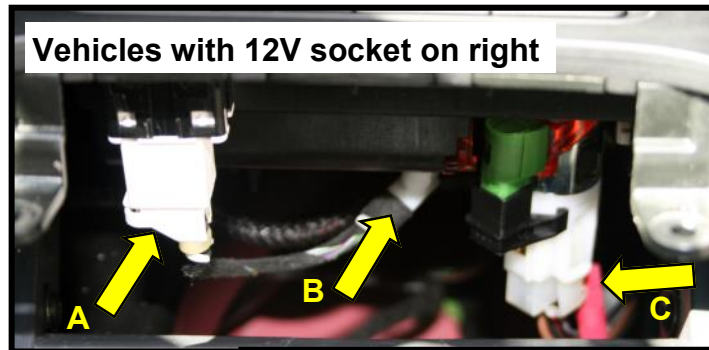

**Step 4:**

Pull the tray assembly up and outward and remove it from its recess. Remove the blank in the desired button location by pushing it out from the underside. Snap the new button into the open position from the top side.

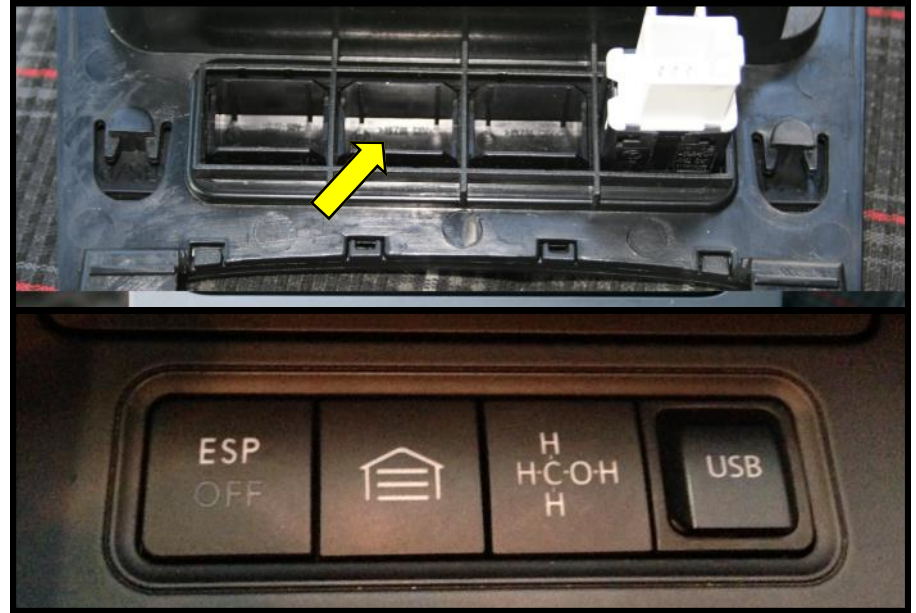

### Step 5:

- A. Connect the fork end of the ground wire to the Torx screw shown in Fig. A and Fig. B.
- B. Route the end of the button harness with the orange connector over or to the side of the fuse panel. Fig. C.
- C. Connect the stripped end of the ground wire to the relay terminal labeled "DC-", yellow arrow Fig D.
- D. Connect the Add-A-Fuse to the relay terminal next to the ground wire. Fig. D.

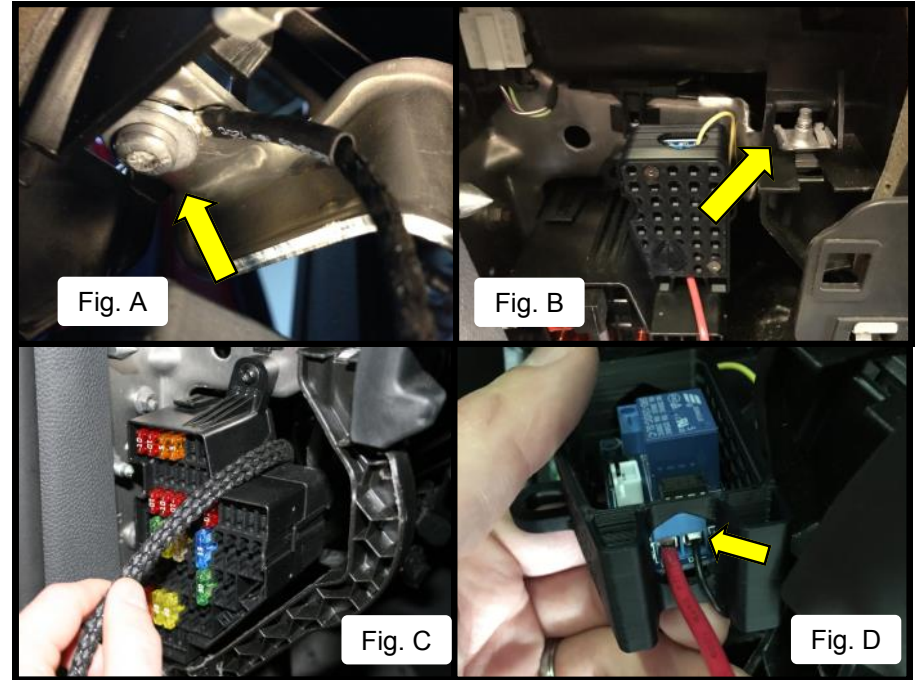



### Step 5 (cont.):

E. Route the white connector on the button harness through the opening in the relay case and connect it as shown in Fig. E.

F. Connect your devices power wire to the relay. If you want the device to come on with vehicle power, connect the power wire to the “NC” terminal. If you’d like power when the button is pushed connect to the “NO” terminal.

If your button has the optional yellow LED and you want it to indicate when power is on, connect the yellow lead on the button harness to the same terminal as your power wire. Alternatively you can use the included large Posi-Tap to connect the yellow wire to your power wire outside of the relay. See Fig. G.

If you want the yellow LED to indicate when power is off, connect the yellow wire to the NC or NO terminal opposite the power wire.

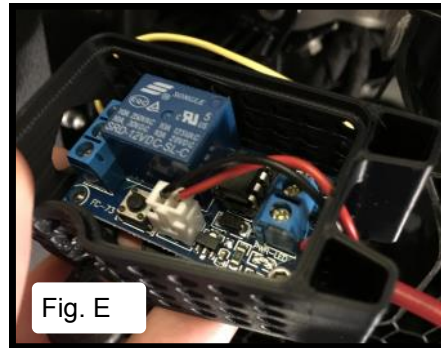

Fig. E

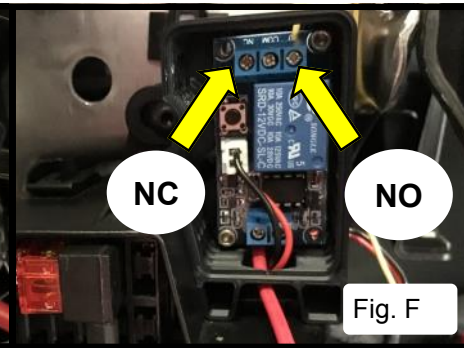

Fig. F

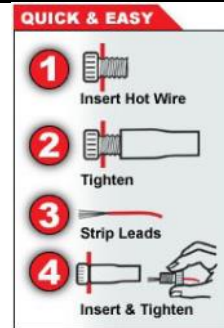

Fig. G



### Step 6:

- A. Route the orange end of the harness over the lower knee bolster support beam.
- B. Route the harness into the center console.
- C. Connect the short, bare leads, originating from the orange button connector, to the traction control button wiring harness. Using the pair of smaller Posi-Taps, connect the red wire to the grey wire on the TC button harness and the black wire to the brown wire on the TC button harness.
- D. Plug the orange connector into the button.

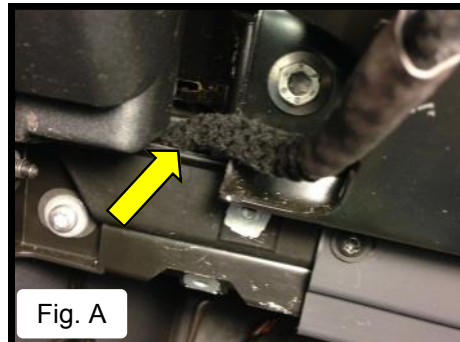

Fig. A

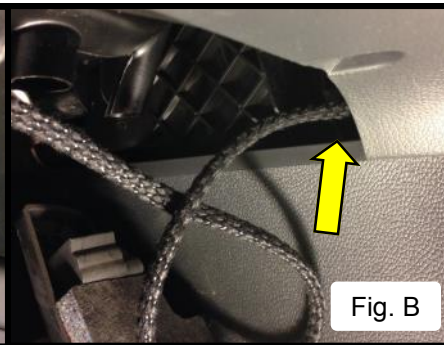

Fig. B



Fig. C

## Step 7

A. Reconnect the battery.

B. Insert the 10A fuse into the Add-A-Fuse in the position shown in Fig. B.

C. The Add-A-Fuse can be plugged into an empty position in the fuse panel that has power or an occupied position. If an occupied position is used remove the fuse from the panel and insert it into the open location on the Add-A-Fuse. We recommend using a switched power source. With a multi meter or test light check that your power source is only live with the ignition in the power on position.

D. Plug the Add-A-Fuse into the fuse box. Orient it so the terminal marked in Fig. B is plugged into the powered terminal in the fuse panel.



## Step 8:

- A. Install the relay case cover with the included screws and a 1/16" Allen key. Screws only need to be hand tight. Secure the relay module to the fuse panel using the included M5 button head bolt, using a 3mm Allen wrench as shown in Fig. A. Make sure the wires coming from the bottom of the case are routed in between the legs and the wires from the top are routed behind the case and not pinched.
- B. Make sure all connections have been made, turn on vehicle power and test the button and relay. **Turn off power when testing complete.**
- C. Secure any harness slack with the included zip ties. The HVAC ducting (Fig. B) and other wire harnesses make good anchor points. Make sure the harness does not interfere with the pedals.

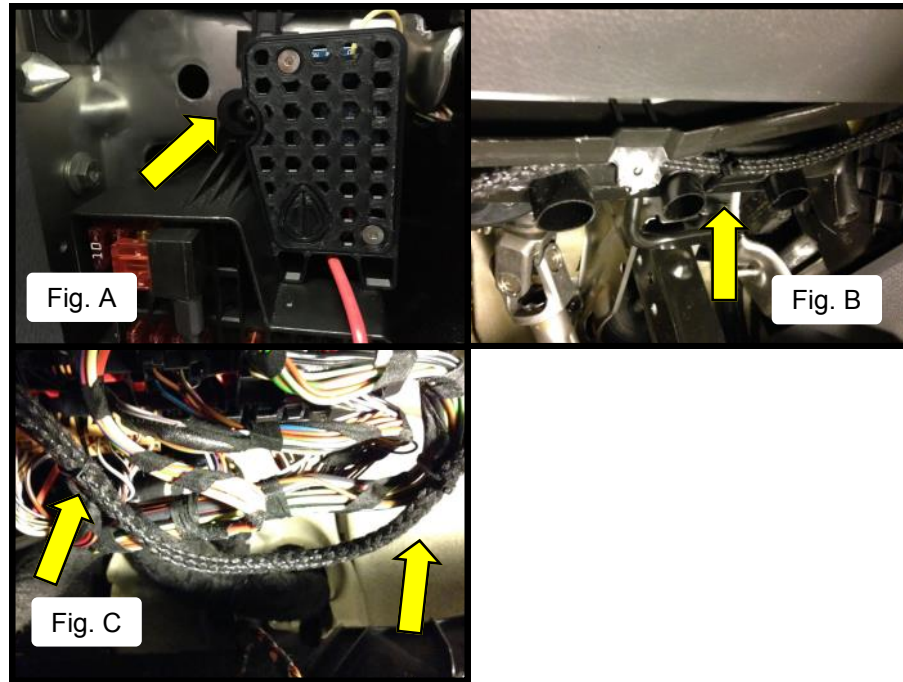

## Step 8 Continued:

E. Reconnect all cables and secure the center tray assembly. Reinstall the shift boot, knee bolster, under dash cover and fuse panel cover.

## Thank You!

Thank you again for choosing the Double Apex Toggle Button Kit. We believe in continuous improvement so until our products install themselves and respond to telepathic commands there's probably something we could do better. All feedback is appreciated. If you have comments or questions please don't hesitate to contact us at [support@doubleapex.co](mailto:support@doubleapex.co) or visit us at [doubleapex.co](http://doubleapex.co).

## Limited Warranty

Double Apex LLC warrants this product to be free from defects in materials and workmanship for one year from date of purchase to the original retail Purchaser.

Double Apex LLC reserves the right to repair or replace the defective product at their discretion, without charge. This is the only remedy the purchaser has for any loss or damage due to any defect in the product. This warranty does not cover labor, lost profits, down time or loss of use, shipping costs, damage to the vehicle or other incidental, indirect or consequential damages.

This warranty is void if the product is misused, abused or installed incorrectly.

The Purchaser is responsible for ensuring that the product is installed correctly and should immediately stop use of the product if an improper or unsafe condition is observed.

Please contact Double Apex LLC to make a warranty claim before returning the product.



[www.doubleapex.co](http://www.doubleapex.co)  
email: [support@doubleapex.co](mailto:support@doubleapex.co)