

ECS TUNING

Installation Instructions - ECS Tuning Vent Pod Vacuum/Boost Gauge Kit



Part Number **ES8017**
for Audi B7/A4
(2005-2008)

This tutorial is provided as a courtesy by ECS Tuning.

Proper service and repair procedures are vital to the safe, reliable operation of all motor vehicles as well as the personal safety of those performing the repairs. Standard safety procedures and precautions (including use of safety goggles and proper tools and equipment) should be followed at all times to eliminate the possibility of personal injury or improper service which could damage the vehicle or compromise its safety.

Although this material has been prepared with the intent to provide reliable information, no warranty (express or implied) is made as to its accuracy or completeness. Neither is any liability assumed for loss or damage resulting from reliance on this material. SPECIFICALLY, NO WARRANTY OF MERCHANTABILITY, FITNESS FOR A PARTICULAR PURPOSE OR ANY OTHER WARRANTY IS MADE OR TO BE IMPLIED WITH RESPECT TO THIS MATERIAL. In no event will ECS Tuning, Incorporated or its affiliates be liable for any damages, direct or indirect, consequential or compensatory, arising out of the use of this material.

Audi B7 A4 Vent Pod Vacuum/Boost Gauge Installation

Kit Contents:

- vacuum/boost gauge
- rubber o-ring for mounting gauge body
- gauge power supply wiring harness
- vacuum/boost sensor (transducer with integral harness)
- gauge vent pod
- 3/8-inch I.D vacuum hose
- rigid plastic hose
- braided rubber hose
- ECS vacuum tee
- clamps (crimp and screw type)
- crimp connectors
- zip ties

Tools

- end nippers or side cutters
- T8, T20, and T25 Torx® drivers
- flat head (common) screwdriver
- electric drill with 3/8-inch drill bit
- razor blade or xacto™ knife
- non-marring plastic removal tool
- work light



The gauge in your kit is used for several applications. The box it comes in contains parts not used in the B7 A4 (and not shown above), including a u-shaped mounting bracket, brass threaded attachment studs, two screws, a plastic vacuum tee, and insulated spade connectors. (Throw them in your tool box for another project.)

Your kit contains both bullet style and butt connectors. Use the bullet connectors to splice the gauge power harness into the light switch harness. Use the butt connectors to connect the extension wire to the power harness. Directions below show how to use the connectors.

Using crimp connectors

1) Cut the headlight harness wire you want to tap into.

Remove enough insulation from both lengths of wire to expose a short length of wire (about 3/8-inch).

Note:

Use a suitable wire stripper that will remove the insulation without cutting away wire strands.

Use a crimping tool of the correct size, not side cutters or other pliers that may damage the insulation on the connectors.

See pages 14 and 15 of this document for a wiring schematic.

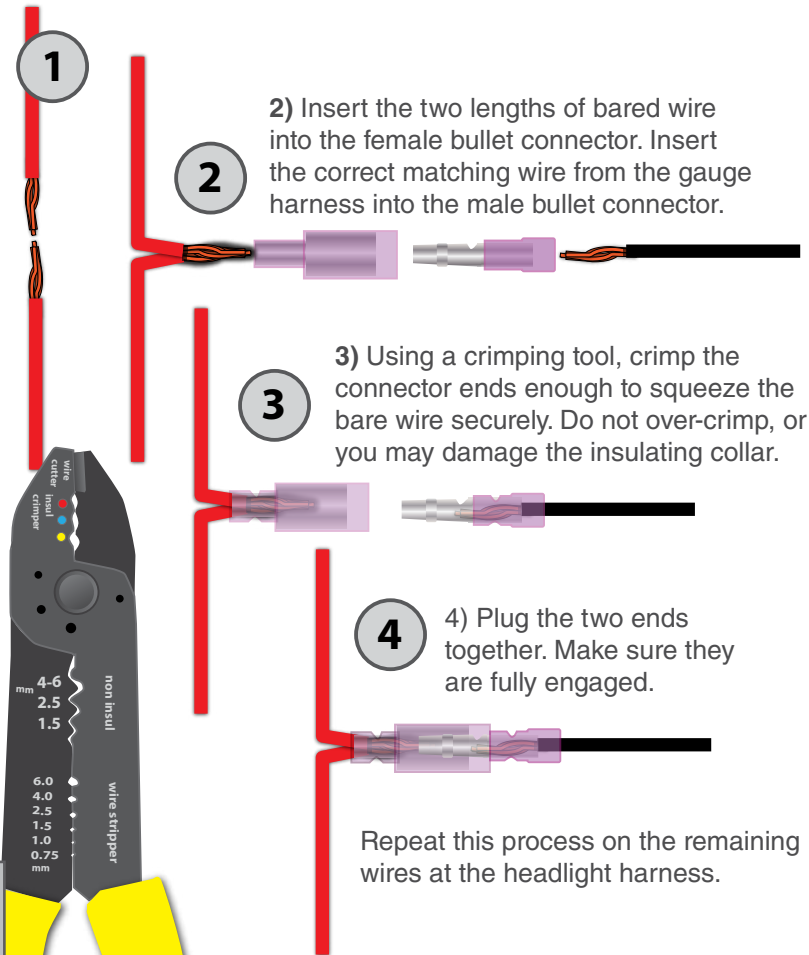

butt connectors

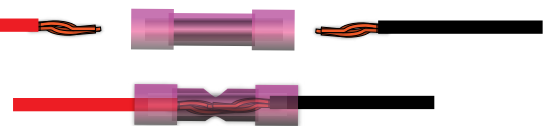

Use the same methods to splice the gauge power harness to the extension harness using butt connectors.

Overview

This tutorial is broken into three sections:

- 1) Run the Vacuum Line** - This section describes how to connect the vacuum tee at the intake manifold. It also shows how to route the rigid vacuum line from the tee through the firewall to the interior of the vehicle, where it is connected to the Vacuum/Boost Transducer.
- 2) Install the Vent Pod and Gauge** - This section shows how to disassemble the dashboard vents, and install the Vent Pod and Vacuum/Boost Gauge.
- 3) Connect the wiring** - This section shows how to route the power harness to the light switch and splice into the headlight switch and ignition switch wiring.

Section 1 - Run the Vacuum Line - Install the Transducer

Step 1 - Remove the engine cover.

Open the hood. Remove the engine beauty cover.

The cover is attached to the engine by push pins inserted into rubber grommets.

Pull or pry the cover free from the grommets and remove it.



Step 2 - Remove the vacuum cap at the intake manifold port.

Locate the rubber cap clamped in place on the vacuum port at the left rear of the intake manifold.

Use end nippers or diagonal pliers to cut the crimp-clamp holding the rubber cap in place.

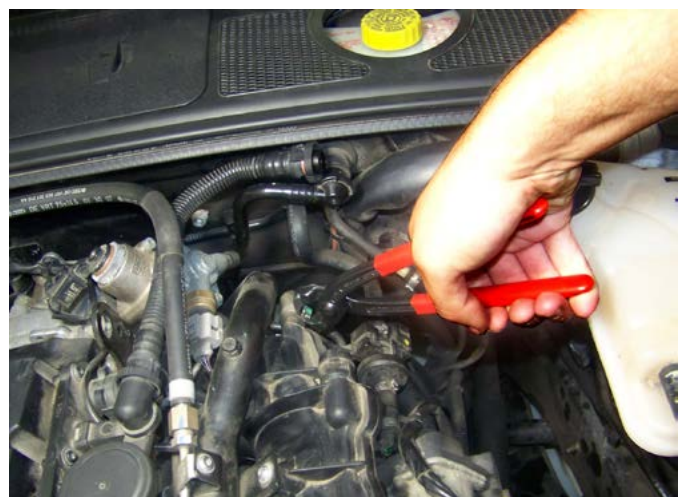

Section 1 - Run the Vacuum Line - Install the Transducer

Audi B7/A4

Step 3 - Remove the vacuum cap at the intake manifold port.

Pull the rubber cap off to expose the vacuum port.

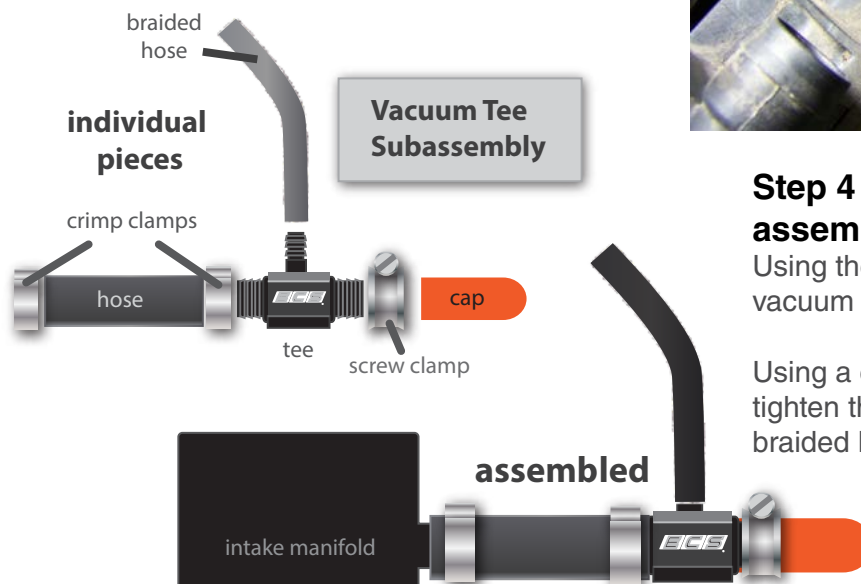
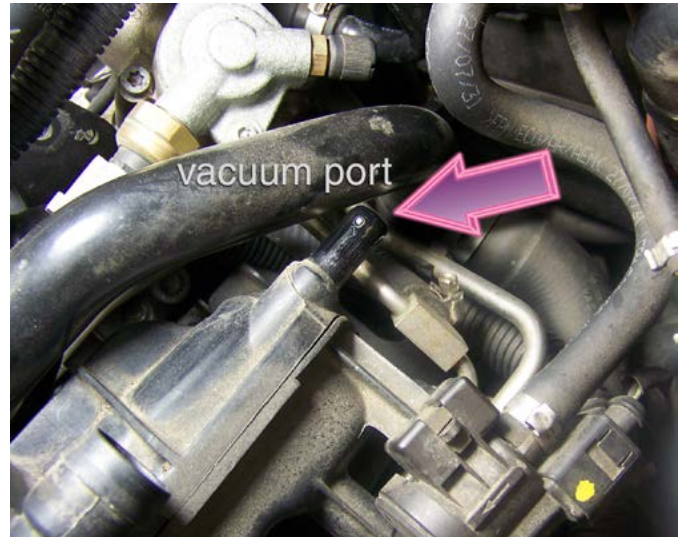

Step 4 - Prepare the vacuum tee assembly.

Using the parts in the kit, prepare the vacuum tee assembly.

Using a clamp crimper or end nippers, tighten the crimp clamps. The small braided hose requires no clamp.

Step 5 - Install the vacuum tee at the intake manifold port.

Install the vacuum tee with the braided rubber hose pointing upward.

Tighten the final crimp clamp at the manifold port (arrow).

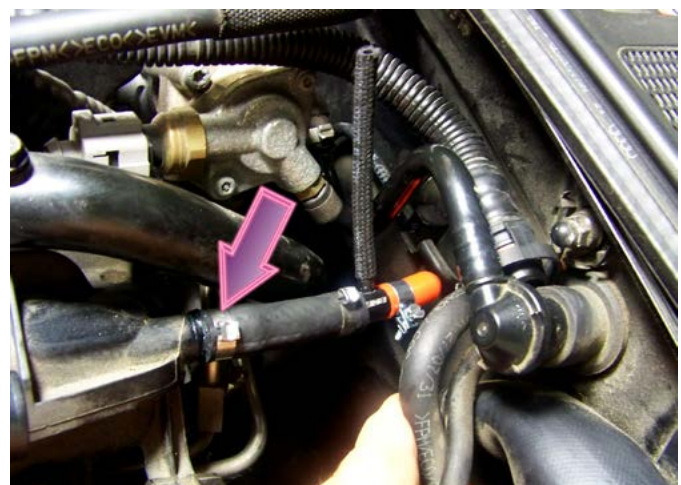

Section 1 - Run the Vacuum Line - Install the Transducer

Audi B7/A4

Step 6 - Remove the water tray weatherstrip.

Peel away the rain tray weatherstrip.



Step 7 - Remove the rain tray.

Slide the water tray forward and out. Lay it aside.



Step 9 - Inside the car-remove the fuse cover.

Move inside the car. Pry out the fuse panel cover from the left side of the dashboard.

Remove the underdash panel screw (arrow).



Section 1 - Run the Vacuum Line - Install the Transducer

Audi B7/A4

Step 10 - Remove the underdash panel.

Remove the remaining two screws from the underdash panel (arrows) and drop the panel down into the footwell.



Step 11 - Remove DLC and light from dash panel.

Disconnect the black/purple data link connector (DLC) (left arrow) and footwell light (right arrow) from the underdash panel; then remove the panel from the car to get it out of your way.



Step 12 - Run the vacuum line.

Locate the main red cable in the firewall that runs from the battery positive to the power distribution panel. It is located just to the left of the clutch pedal return spring mechanism, highlighted here inside the orange oval.

The power cable is routed through a heavy rubber grommet in the firewall. There is an open location right next to the cable hole, with a molded recess.

Using a long thin, sharp, punch, poke a hole in the empty recess. Then push the rigid plastic cable in the kit through the hole, into the water tray.

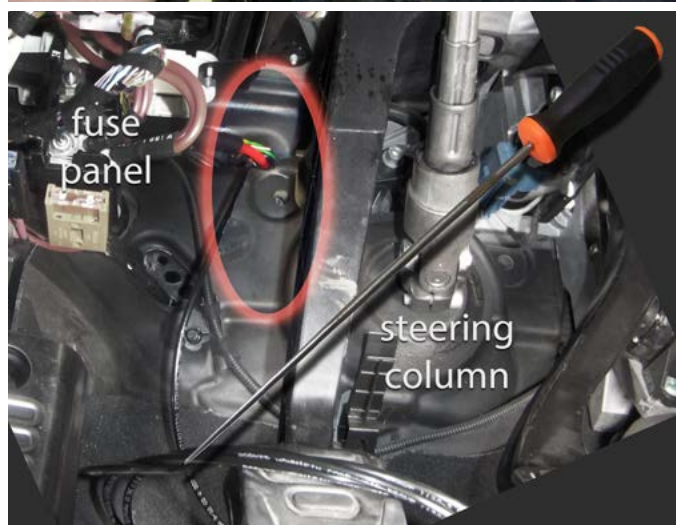

Section 1 - Run the Vacuum Line - Install the Transducer

Audi B7/A4

Step 13 - Run the vacuum line.

The plastic line will exit the grommet in the water tray in the general area between the computer and brake vacuum booster.

You may find it helpful to have someone under the hood to snag the line when it appears, and help pull it through.



Step 14 - Under the hood - Connect the rigid vacuum line.

Under the hood

- Route the rigid vacuum line along the water tray in front of the battery.
- Push it through the large negative battery cable grommet.
- Route the line back across the front of the water tray to the braided hose at the vacuum tee.
- Connect the rigid line to the braided hose at the tee.
- Use zip ties to secure the plastic line. **Do not pull the line it too tight at the vacuum tee. Leave a slight bend in the soft hose to compensate for engine movement.**

Beneath the dash

Using short lengths of braided hose, connect the plastic line, moisture filter, and transducer.

Using zip ties, secure all lines and hoses so they will not interfere with any components.

Let the transducer wire harness hang free for now.

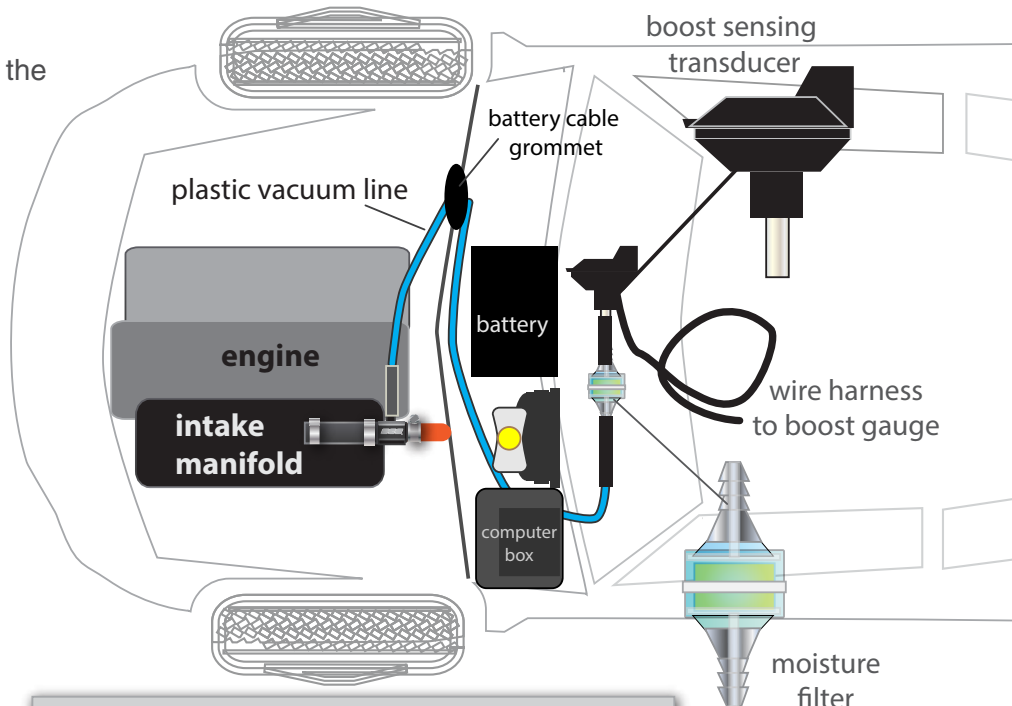

**Vacuum Routing Map
Audi B7 A4 Vacuum/Boost Gauge**

Section 2 - Install the Vent Pod and Gauge

Audi B7/A4

Step 1 - Loosen the vent.

Using a plastic, non-marring trim removal tool, pry the center vent assembly from the dash. Pry carefully at several places until the entire vent assembly pops out.

ECS sells two trim removal tool sets, ideal for removing interior trim panels and other plastic components: [ES2500877](#) and [ES517779](#).



Step 2 - Remove the vent.

Slide the vent assembly out of the dash and disconnect the yellow electrical connector at the rear.



Step 3 - Remove the vent front cover.

With the assembly removed from the dash, pry on the plastic retainer clips securing the front cover to the vent housing.

When all tabs are released, separate the vent housing and front cover.



Section 2 - Install the Vent Pod and Gauge

Audi B7/A4

Step 4 - Remove the horizontal louvers.

Using a flat-bladed trim removal tool or a small common screwdriver, pry on the horizontal louvers to remove them.



Step 5 - Remove the vertical louvers.

Using a flat-bladed trim removal tool or a small common screwdriver, pry on the vertical louvers to remove them.



Step 7 - Drill the harness hole.

With all louvers removed, drill a 3/8-inch hole in the bottom of the vent opening, at the location shown.

We will route the gauge wiring harnesses through this hole to the back of the vacuum boost gauge, when it is installed.

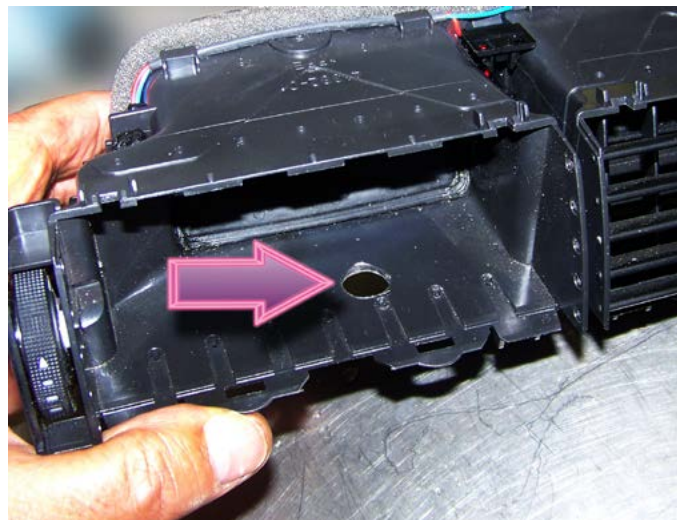

Section 2 - Install the Vent Pod and Gauge

Audi B7/A4

Step 8 - Install the o-ring on the gauge.

Lightly lubricate the rubber o-ring in the kit and slide it around the gauge body, as shown (arrow).



Step 9 - Install the gauge in the pod.

Insert the gauge into the pod opening. Grip the base of the pod at its strongest point, as shown. Then push and twist the gauge at the same time until it sits flush with the pod.

Rotate the gauge after it is fully seated to properly align it in the pod.



Step 10 - Route the harnesses.

Locate the connector end of the boost sensor transducer harness.

Temporarily tie it to the power harness from the kit, then route both harnesses up through the side of the center console to the vent opening in the dash.

See the next image for a schematic showing the harness routing.



Section 2 - Install the Vent Pod and Gauge

Audi B7/A4

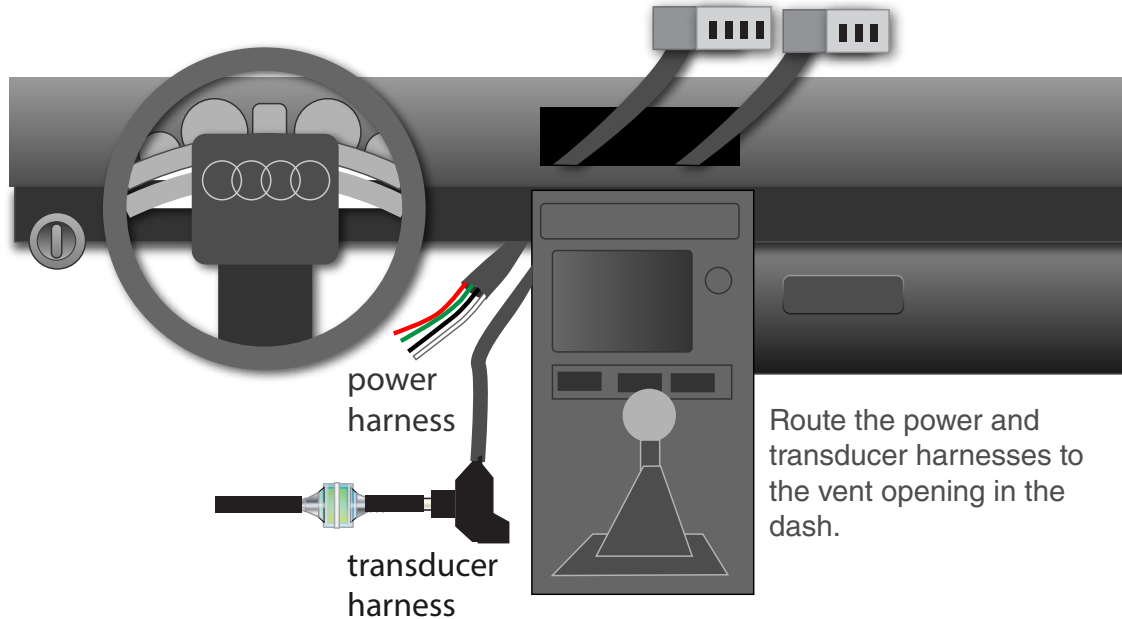

Step 11 - Route the harnesses.

Connect the two harnesses to the back of the gauge.



Step 12 - Install the vent pod.

Install the vent pod assembly into the vent housing.

Align the small pins in the ends of the individual louvers with the mating holes in the vent housing.

(See next image for close-up photo.)



Section 2 - Install the Vent Pod and Gauge

Audi B7/A4

Step 13 - Install the vent pod.

This close-up shows the louver pins and mating holes in the vent housing. Align the pins on both sides of the vent pod carefully as you install them to prevent breakage.



Step 14 - Install the front cover.

Reinstall the front cover removed in Step 3. Snap it back in place.

Reconnect the small yellow electrical connector at the rear of the vent assembly.



Step 15 - Install the vent assembly.

Slide the entire vent assembly back into the dash opening, being careful not to pinch any wiring. Push evenly until the retainer clips snap in place.

If you haven't already done so, you can peel off the protective plastic film from the gauge face.



Section 3 - Connect the Gauge Wiring

Audi B7/A4

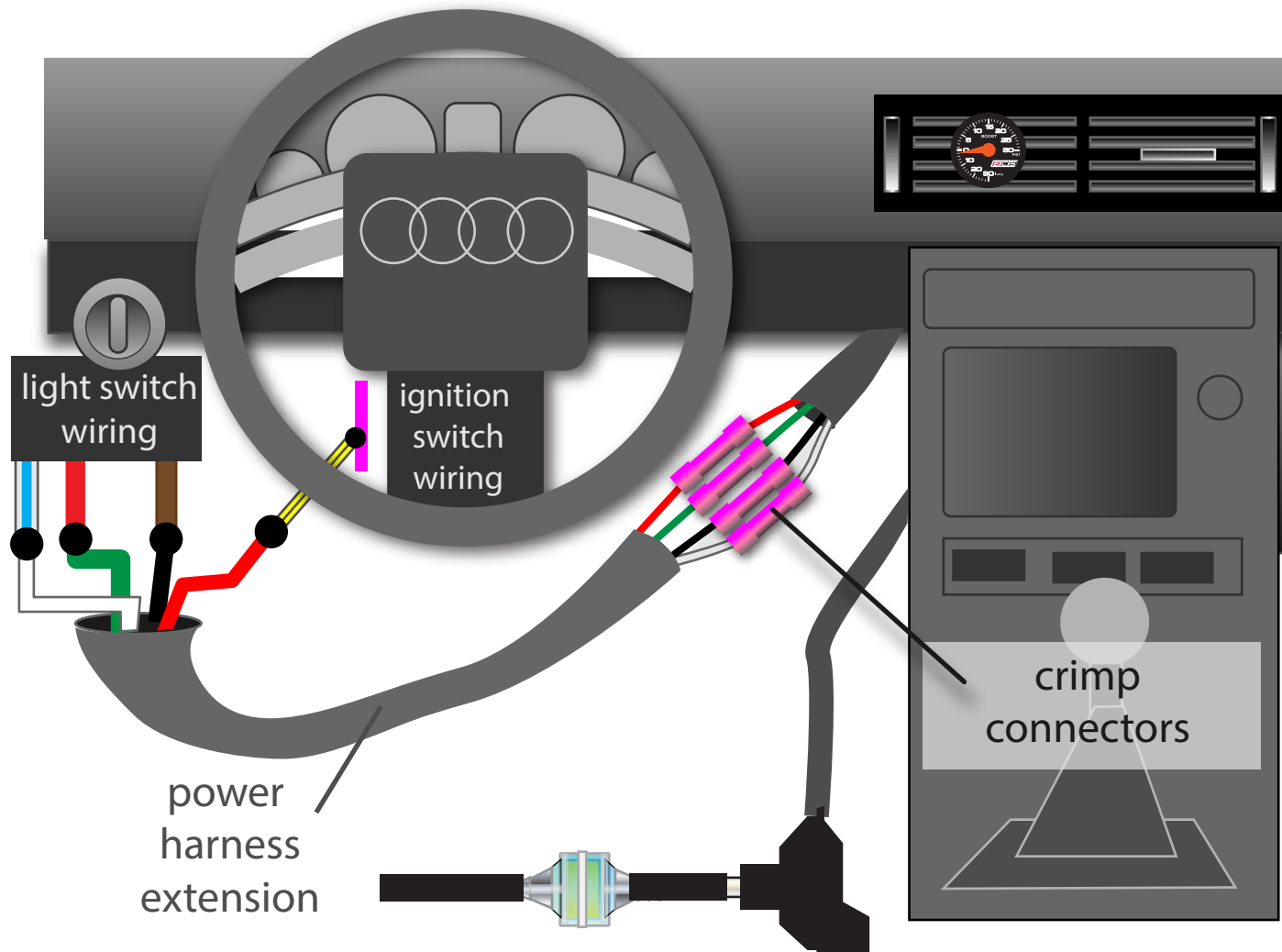

Use the length of wire in the kit with the crimp connectors to extend the length of the power harness.

Route it beneath the dash to the left side of the dashboard in the general area near the headlight switch.

The image on the next page shows splice locations in greater detail.

Section 3 - Connect the Gauge Wiring

Audi B7/A4

This schematic shows the wire connections at the headlight switch and ignition wire bundle.

Vacuum/Boost Gauge Power Harness Wiring

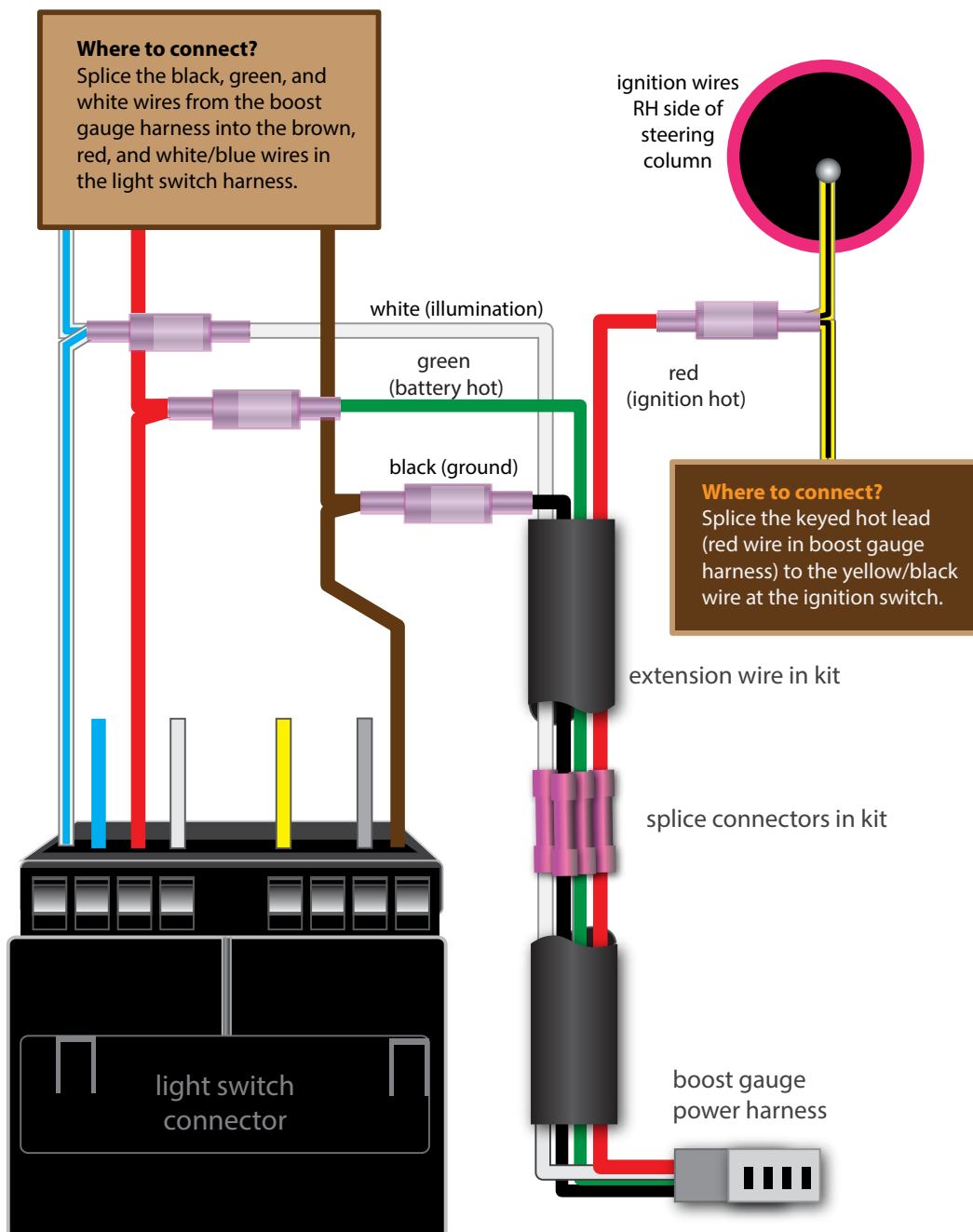

ES8017

Section 3 - Connect the Gauge Wiring

Audi B7/A4

Step 1 - Removing the light switch.

To access the electrical wiring at the rear of the headlight switch, first remove it from the dash.

To remove the switch: Push in on the center knob and rotate it to a position between OFF and AUTO.

Then pull the switch straight out of the dash and unplug it from its electrical connector.



Step 2 - Remove the DRL switch.

Pull the daytime running light (DRL)/coming home/leaving home switch body from the dash and disconnect it.

Then pull the two light switch wiring harnesses back through the dash.



Step 3 - Splice wiring at light switch.

With the headlight switch harness connector pulled away from the dash, there is ample room to make your splice connections using the schematic on the previous page.



Section 3 - Connect the Gauge Wiring

Audi B7/A4

Step 4 - Splice wiring at ignition switch.

To complete the wiring connections, remove the plastic clam shell trim surrounding the steering column to expose the ignition switch wiring.

Using Torx drivers, remove the two T8 and single T25 screws from the lower cover (see next photo). Then pry carefully at the horizontal seam between the upper and lower covers to separate them.

Remove the lower cover



Step 5 - Dash cover screw locations.

This photo shows the lower cover removed to give you a better view of the three screw locations.



Step 6 - Splice into ignition wire.

Locate the yellow wire with black tracer at the ignition wire bundle (arrow). Splice the last wire from the vacuum/boost harness (red) into this wire.

With all wires connected and properly insulated, test gauge operation and illumination.

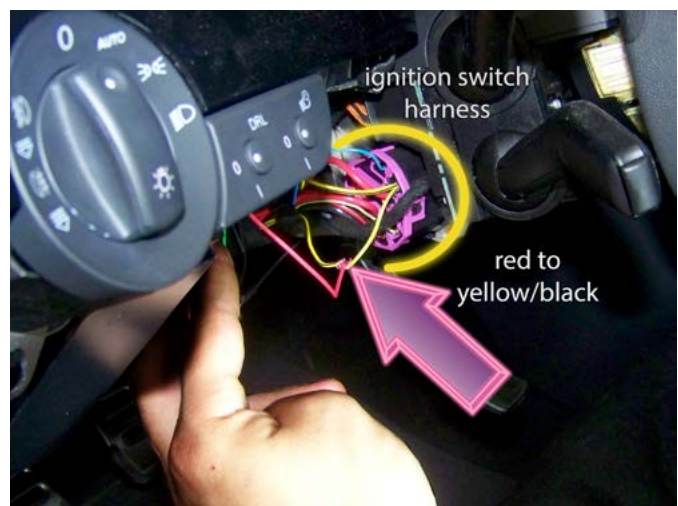

ECS Tuning Vent Pod Vacuum/Boost Gauge Kit
for Audi B7/A4 models.

ES8017



Audi B7/A4

Step 7 - Gauge initialization

Each time you turn the ignition to the on position, the vacuum/boost gauge should initialize. This is normal.

Key-on, the gauge needle will initialize. It will sweep back and forth between maximum vacuum and boost before settling at zero. This is normal.

Once the engine starts, the needle indicates either engine vacuum or boost, depending on engine conditions.



Step 8 - Complete the job

Reinstall the light switches in the dash. Before reinstalling the underdash and underhood panels, take time to inspect all lines, hoses, and wiring to be sure they are properly secured with zip ties, and that none of them interferes with any moving object.

Be extra careful to route them away from the steering column and pedals.

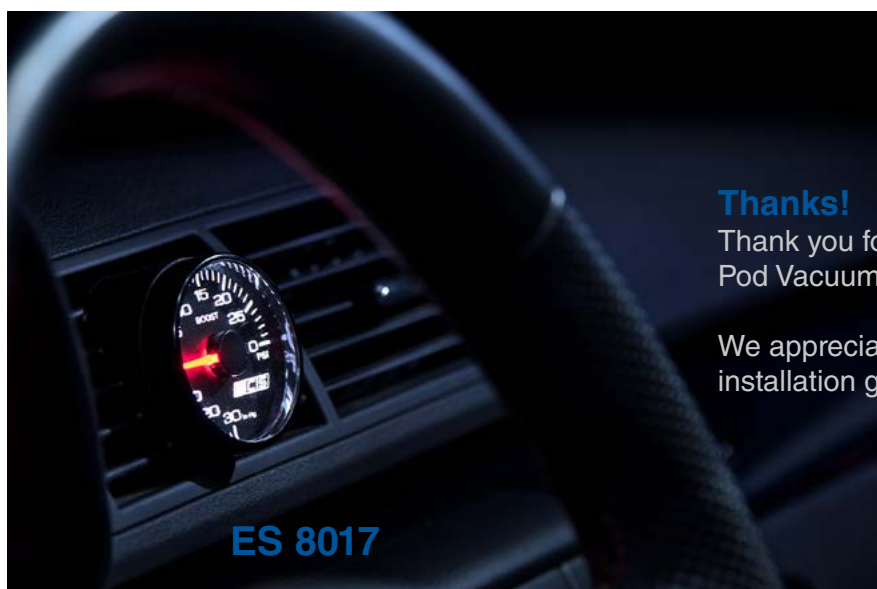

Thanks!

Thank you for purchasing the ECS Tuning Vent Pod Vacuum/Boost Gauge.

We appreciate your business, and hope this installation guide has been helpful.