

Original BMW Accessories. Installation Instructions.



Retrofit - 17" BMW Performance Brake System

BMW 1 Series (E81/E82/E87/E88)

BMW 3 Series (E90/E91/E92/E93)

Not available for all BMW 3 Series xDrive, 330i (ACEA*) and 330d built before 09/09, 335i and 335d.

*ACEA countries (Association of European Automobile Manufacturers): EU, Switzerland, Iceland, Serbia and Montenegro, Croatia, Macedonia, Bosnia-Herzegovina, French Guyana, Guadeloupe, Martinique, Reunion.

For all other vehicles, retrofit kit only suitable for 4-cylinder engines as from 03/07 and 6-cylinder engines as from 06/06.

Retrofit kit only suitable for approved wheels (see Section 6)

| | | |
|-------------------------|-----------------|--|
| Retrofit kit No. | 34 11 0 444 772 | Retrofit kit - Sports brakes, front axle and rear axle |
| | 34 11 0 444 771 | Retrofit kit - Sports brakes, front axle and rear axle |
| | 34 11 0 444 738 | Retrofit kit - Sports brakes, front axle |
| | 34 11 0 444 769 | Retrofit kit - Sports brakes, front axle and rear axle |
| | 34 11 0 444 766 | Retrofit kit - Sports brakes, front axle and rear axle |

Installation time

The installation time of **approx. 3.5 hours** may vary depending on the vehicle's condition and equipment.

The vehicle must be updated to the latest integration level status by flashing before installing the retrofit. Differing programming times may be necessary depending on the production age of the vehicle and on work previously performed on the vehicle.

The installation time given does not include time needed for programming/encoding.

The total costs for the programming time should be taken into account when calculating retrofitting costs (reimbursement through warranty is not permissible).

Important information

Hand out the customer information G (Part No. 01 29 0 444 871) to the customer.

These installation instructions are primarily designed for use within the BMW dealership organisation and by authorised BMW service companies.

In any event, the target group for these installation instructions is specialist personnel trained on BMW cars with the appropriate specialist knowledge.

All work must be completed using the latest BMW repair manuals, circuit diagrams, servicing manuals and work instructions, in a rational order, using the specified tools (special tools) and observing current health and safety regulations.

In the event of installation or functional problems, limit troubleshooting to 0.5 hours for mechanical jobs and 1.0 hours for electrical jobs.

To avoid unnecessary work and costs, send a corresponding enquiry via the Aftersales Assistance Portal (ASAP) using the technical parts support application.

Please quote the following:

- Vehicle identification number
- Part number of retrofit kit
- Exact description of the problem
- Work already carried out

Do not archive the hard copy of these installation instructions since daily updates are made by ASAP!

All illustrations show LHD vehicles; follow the same procedure on RHD vehicles.

Pictograms



Denotes instructions that draw your attention to dangers.



Denotes instructions that draw your attention to special features.

- ◀ Denotes the end of the instruction or other text.

Special tools required

34 1 050 Brake piston tool

Important documentation and information for the customer

The workshop certificate (see Annex) is to be completed and handed over to the customer together with the customer information G and TÜV component certificate (see Annex).

It must be pointed out to the customer that the brake system will require acceptance and the vehicle documents will need to be amended as the brake system will be changed in the approval and homologation data. Correct installation must be certified by an officially recognised expert.



Carefully run in the BMW Performance Brake System over the first 200 km. The brake system will then exhibit its sports properties to the full extent. ◀



In view of the special design features of the brake discs with holes, noise may occur while braking, however, this has no influence whatsoever on the stability of the brake discs. ◀

Installation information

The parts kits for the 17" BMW Performance Brake System retrofit can be installed on the following vehicles:

| Kit No. | 34 11 0 444 772 (FA + RA) | 34 11 0 444 771 (FA + RA) | 34 11 0 444 738 (FA only) | 34 11 0 444 769 (FA + RA) | 34 11 0 444 766 (FA + RA) |
|---------|--|---|---|--|------------------------------|
| Model | E82/E88 118i (only E88) 120i (only E88) 125i 128i 118d 120d | E81/E87 116i 118i 120i 116d 118d 120d E90/E92 316i 316d (only E90) | E81/87 130i 123d E90/E92 318i (only E90) 320i 323i 325i 328i 318d (only E90) 320d E91/E93 4-cyl. from 09/09 316i (only E91) 318i (only E91) 320i without option SA217** 316d (only E91) 318d (only E91) 320d without option SA217** | E91/E93 4-cyl. to 09/09 316i (only E91) 318i (only E91) 320i 316d (only E91) 318d (only E91) 320d 4-cyl. from 09/09 320i with option SA217** 320d with option SA217** 6-cyl. 323i 325i 328i E9x 330i 330i (ACEA*) as from 09/09 325d 330d as from 09/09 | E82/E88 123d |

Not available for all BMW 3 Series xDrive, 330i (ACEA*) and 330d built before 09/09, 335i and 335d.

*ACEA countries (Association of European Automobile Manufacturers): EU, Switzerland, Iceland, Serbia and Montenegro, Croatia, Macedonia, Bosnia-Herzegovina, French Guyana, Guadeloupe, Martinique, Reunion.

** Note: Option SA217 = Active steering

Contents

| Section | Page |
|---|------|
| 1. Parts overview, front axle | 5 |
| 2. Parts overview, rear axle | 6 |
| 3. Preparatory work | 7 |
| 4. Installation - front axle | 8 |
| 5. Installation - rear axle | 9 |
| 6. Approved wheels | 11 |
| 7. Finishing off and coding | 12 |
| Workshop certificate | |
| TÜV component certificate 08-00017-CP-GBM-... (including all supplements) (For parts kit No. 34 11 0 444 766 and 34 11 0 444 769) | |
| TÜV component certificate 08-00047-CP-GBM-... (including all supplements) (For parts kit No. 34 11 0 444 738, 34 11 0 444 771 and 34 11 0 444 772) | |

1. Parts overview, front axle

 Components for all kit numbers. Kit number 34 11 0 444 738 only contains components for the front axle. ◀

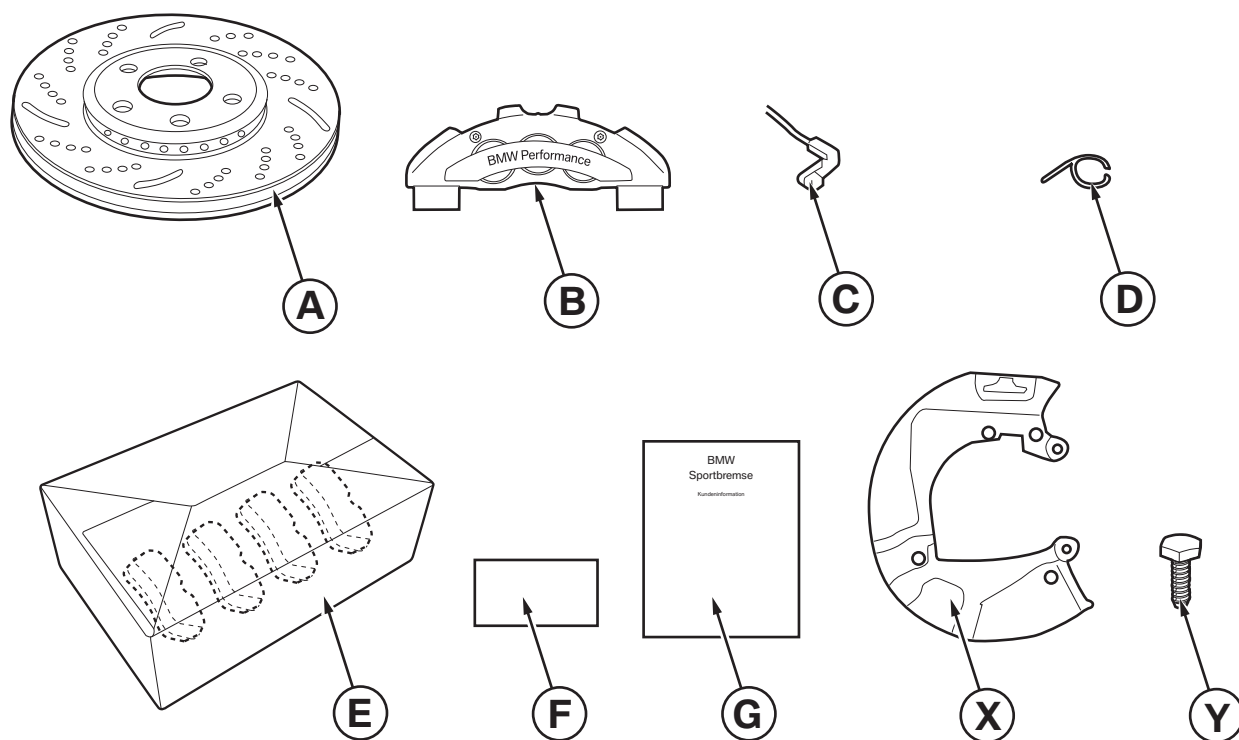

090 0377 V

Legend

- A** Front disc brake, holed (2x)
- B** Front brake calliper (2x)
- C** Front brake pad sensor
- D** Clip for front brake pad sensor
- E** Front brake pad (4x)
- F** Adhesive label
- G** Customer Information
- X** Brake guard plate (2x)
- Y** Screw for guard plate (8x)

2. Parts overview, rear axle

 Not for kit number 34 11 0 444 738. ◀

a) For kit number 34 11 0 444 771 and 34 11 0 444 772

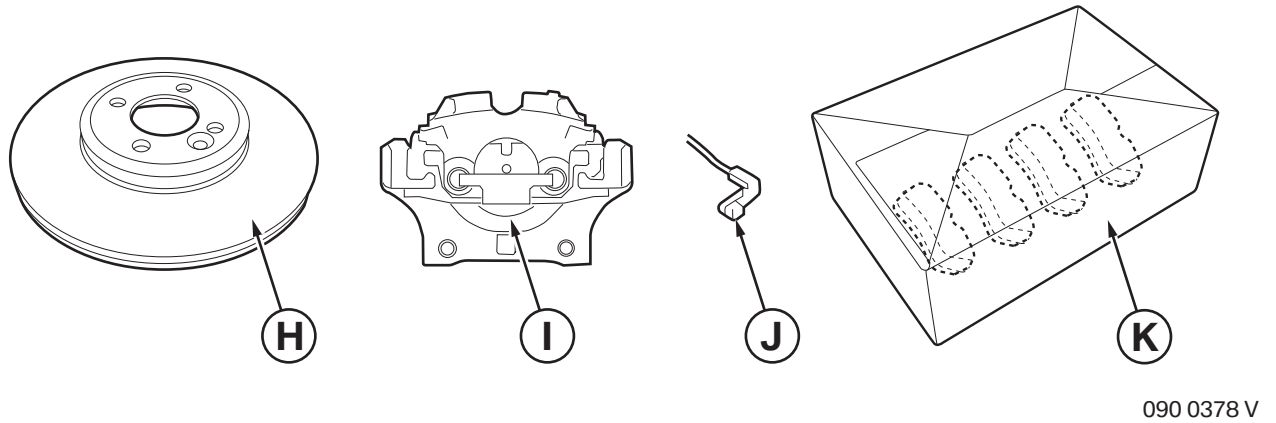

 For front axle, see Section 1, Parts Overview Front Axle, Page 4. ◀

a) For kit number 34 11 0 444 766 and 34 11 0 444 769

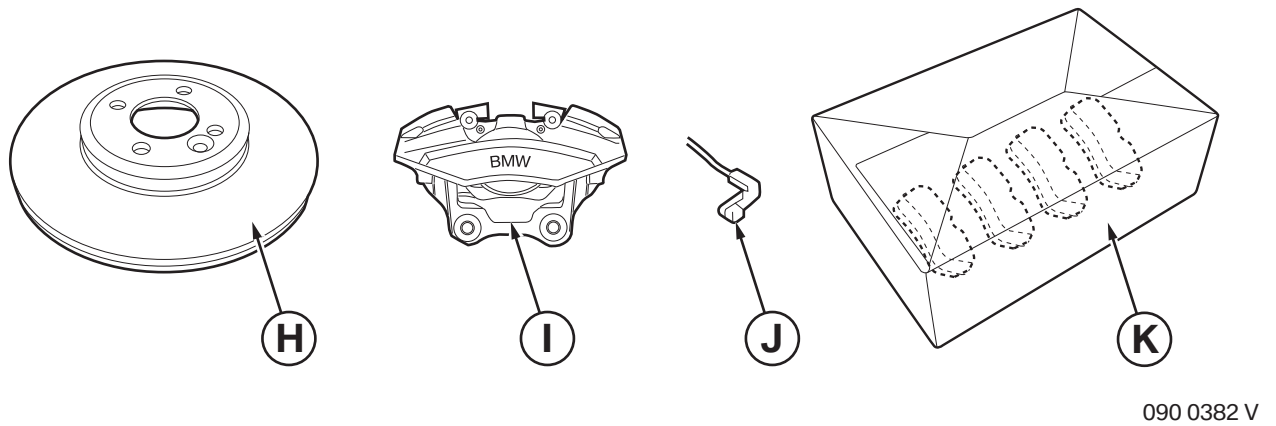

 For front axle, see Section 1, Parts Overview Front Axle, Page 4. ◀

Legend

- H** Brake disc, rear (2x)
- I** Brake calliper, rear (2x)
- J** Brake pad sensor, rear
- K** Brake pad, rear (4x)

3. Preparatory work

| | ISTA No. (REP) |
|--|----------------|
| Perform quick test | --- |
| Disconnect negative terminal of battery | 12 00 ... |
| Remove the following components | |
| Remove front and rear wheels (only front wheel for kit number 34 11 0 444 738) | 36 10 300 |
| Remove front brake pad sensor | 34 35 001 |
| Brake pads, front | 34 11 000 |
| Brake calliper, front (only for Teves brakes) | 34 11 020 |
| Brake calliper, front (only for Brembo brakes) | 34 11 520 |
| Brake disc, front | 34 11 220 |
| Remove front guard plates | 34 11 250 |
| Remove rear brake pad sensors (not for kit number 34 11 0 444 738) | 34 35 003 |
| Remove rear brake pads (not for kit number 34 11 0 444 738) | 34 21 200 |
| Remove rear brake calliper (not for kit number 34 11 0 444 738) | 34 21 745 |
| Remove rear brake disc (not for kit number 34 11 0 444 738) | 34 21 320 |

4. Installation - front axle

For all vehicles:

Install following parts according to ISTA No. (REP):

- Install front brake pad sensors **C** and clip **D** according to ISTA No. (REP) 34 35 001.
- Install front brake calliper **B** according to ISTA No. (REP) 34 11 519.
- Install front brake pads **E** according to ISTA No. (REP) 34 11 000.
- Install front brake discs **A** according to ISTA No. (REP) 34 11 220.
- Install brake guard plate **X** according to ISTA No. (REP) 34 11 250.

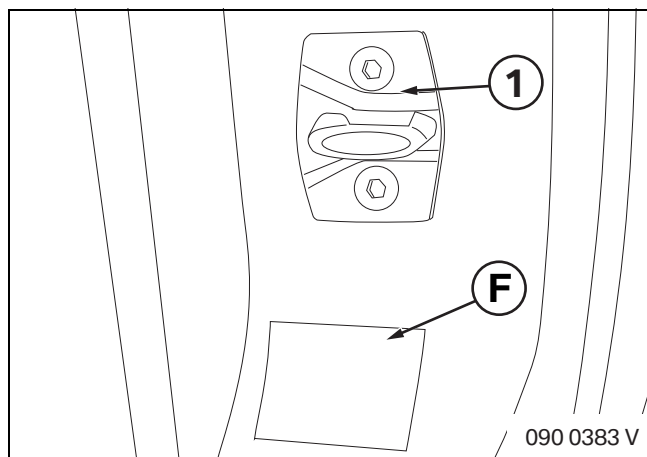

 The adhesion area for the sticker must be free of dust and grease. ◀

Affix label **F** on the driver's side B-pillar under the door lock (1).

5. Installation - rear axle



Not for kit number 34 11 0 444 738. ◀

The BMW Performance Brake System is installed on the front and rear axle of the vehicles listed below. The BMW Performance Brake System can only be installed on the front axle of vehicles not listed below. ◀

| Kit No. | 34 11 0 444 772 (FA + RA) | 34 11 0 444 771 (FA + RA) | 34 11 0 444 738 (FA only) | 34 11 0 444 769 (FA + RA) | 34 11 0 444 766 (FA + RA) |
|---------|--|---|---|--|------------------------------|
| Model | E82/E88 118i (only E88) 120i (only E88) 125i 128i 118d 120d | E81/E87 116i 118i 120i 116d 118d 120d E90/E92 316i 316d (only E90) | E81/87 130i 123d E90/E92 318i (only E90) 320i 323i 325i 328i 318d (only E90) 320d E91/E93 4-cyl. from 09/09 316i (only E91) 318i (only E91) 320i without option SA217** 316d (only E91) 318d (only E91) 320d without option SA217** | E91/E93 4-cyl. to 09/09 316i (only E91) 318i (only E91) 320i 316d (only E91) 318d (only E91) 320d 4-cyl. from 09/09 320i with option SA217** 320d with option SA217** 6-cyl. 323i 325i 328i E9x 330i 330i (ACEA*) as from 09/09 325d 330d as from 09/09 | E82/E88 123d |

Not available for all BMW 3 Series xDrive, 330i (ACEA*) and 330d built before 09/09, 335i and 335d.

*ACEA countries (Association of European Automobile Manufacturers): EU, Switzerland, Iceland, Serbia and Montenegro, Croatia, Macedonia, Bosnia-Herzegovina, French Guyana, Guadeloupe, Martinique, Reunion.

** Note: Option SA217 = Active steering

5. Installation - rear axle

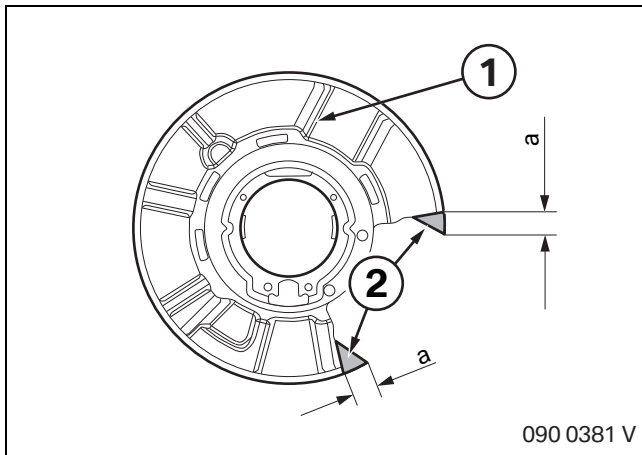

For vehicles built before 08/07:

Transfer dimension $a = 24$ mm to the outer edge of brake guard plate (1). Use a suitable tool to move the marked areas (2) on brake guard plate (1), debur, ensure the brake calliper moves smoothly over at least 5 mm and then treat with standard BMW corrosion protection measures.



Brake guard plate remains on the vehicle. ◀

- Install rear brake pad sensor **J** according to ISTA No. (REP) 34 35 001.
- Install rear brake calliper **I** according to ISTA No. (REP) 34 11 519.
- Install rear brake pads **K** according to ISTA No. (REP) 34 21 200.
- Install rear brake discs **H** according to ISTA No. (REP) 34 21 320.

6. Approved wheels



After installing the 17" BMW Performance Brake System, only the following genuine BMW light-alloy wheels larger than or equal to 17" may be used. This requirement also applies to winter tyres. ◀

7. Finishing off and coding

The retrofit system requires encoding.

- Reconnect vehicle battery
- Encode retrofit with Software Service Station (SSS) via the path – **Retrofit / Sports Brake** –
- Perform quick test
- Reassemble vehicle in reverse order of removal
- Perform function test

The workshop certificate (see Annex) is to be completed and handed over to the customer together with the customer information **G** and TÜV component certificate (see Annex).

It must be pointed out to the customer that the brake system will require acceptance and the vehicle documents will need to be amended as the brake system will be changed in the approval and homologation data. Correct installation must be certified by an officially recognised expert.



Important customer information: Carefully run in the BMW Performance Brake System over the first 200 km. The brake system will then exhibit its sports properties to the full extent. ◀



In view of the special design features of the brake discs with holes, noise may occur while braking, however, this has no influence whatsoever on the stability of the brake discs. ◀



Workshop certificate

The BMW Performance Brake System was installed in accordance with installation instructions No. 01 29 0 444 739 and the TÜV component certificate.

TÜV component certificate 08-00017-CP-GBM-... (including all supplements)
applies to parts kit No. 34 11 0 444 766 and 34 11 0 444 769.

TÜV component certificate 08-00047-CP-GBM-... (including all supplements)
applies to parts kit No. 34 11 0 444 738, 34 11 0 444 771 and 34 11 0 444 772.

"Retrofit - Sports Brakes" coding was performed.

Vehicle type: _____

Vehicle identification No.: _____

Parts kit No.: _____

Vehicle owner: Name and address: _____

Place, date

Signature