



Volkswagen MK6 Golf/GTI/Golf R
Hatch Pop Kit
Installation Instructions



Proper service and repair procedures are vital to the safe, reliable operation of all motor vehicles as well as the personal safety of those performing the repairs. Standard safety procedures and precautions (including use of safety goggles and proper tools and equipment) should be followed at all times to eliminate the possibility of personal injury or improper service which could damage the vehicle or compromise its safety.

INTRODUCTION

ECS Tuning Volkswagen MK6 Hatch Pop Kit

The ECS Tuning Volkswagen MK6 Hatch Pop Kit offers the following features:

- Makes your hatch open completely with the push of a button
- Simple installation
- Complete with all necessary components
- Utilizes your original key fob
- No coding necessary

ECS Difficulty Gauge



1 - Easy

2 - Moderate

Pro - 4

Advanced - 3

Installing the Volkswagen MK6 Hatch Pop Kit is an easy afternoon project that you will be able to complete in about an hour. These step by step instructions will provide you with a smooth, trouble free installation. Thank you for purchasing our ECS Tuning Volkswagen MK6 Hatch Pop Kit. We appreciate your business!

TABLE OF CONTENTS

Kit Contents.....	pg.3
Required Tools and Equipment.....	pg.4
Shop Supplies and Materials.....	pg.4
Installation Notes and Safety.....	pg.5
Hatch Pop Kit Installation.....	pg.6

KIT CONTENTS



Ball Studs



Washers



Gas Struts

REQUIRED TOOLS

Note: The tools required for each step will be listed by the step number throughout these instructions.

Below is a list of the tools we used to install the Volkswagen MK6 Hatch Pop Kit. Additional tools may be required for any issues that arise during installation such as rust, corrosion, or broken and stripped fasteners.

- Flat Blade Screwdriver(s) Available at [ecstuning.com](#) [ES#2225921](#)
- Torx Bit Sockets: T30 Available at [ecstuning.com](#) [ES#11418](#)
- 3/8" Sockets: 13mm Deep
- 3/8" Drive Ratchet

SHOP SUPPLIES AND MATERIALS

- Hand Cleaner/Degreaser Available at [ecstuning.com](#) [ES#2167336](#)
- Shop Rags Available at your local auto parts store
- Aerosol Spray Lubricant/Penetrating Oil Available at your local auto parts store

INSTALLATION NOTES

- **RH** refers to the *passenger side* of the vehicle.
- **LH** refers to the *driver side* of the vehicle.
- Always use the proper torque specifications.
- If applicable to this installation, torque specifications will be listed throughout the document and at the end as well.
- Please read all of these instructions and familiarize yourself with the complete process **BEFORE** you begin.

GENERAL PREPARATION AND SAFETY INFORMATION

ECS Tuning cares about your health and safety. Please read the following safety information. This information pertains to automotive service in general, and while it may not pertain to every job you do, please remember and share these important safety tips.

- Park your car in a safe, well lit, level area.
- Shut the engine off and remove the key from the ignition switch.
- Make sure any remote start devices are properly disabled.
- **ALWAYS** wear safety glasses.
- Make sure the parking brake is applied until the vehicle is safely lifted and supported.
- If using an automotive lift, be sure and utilize the factory specified lift points. Lifting a vehicle in an incorrect location can cause damage to the suspension/running gear.
- When lifting a vehicle using a jack, always utilize the factory specified lift points. Lifting a vehicle in an incorrect location can cause damage to the suspension/running gear. **ALWAYS** support the vehicle with jack stands.
- **ALWAYS** read and follow all safety information and warnings for the equipment you are using.



Never get underneath a vehicle that is supported only by a jack. Always make sure that the vehicle is securely supported on jack stands.

HATCH POP KIT INSTALLATION

Step 1:

Open the rear hatch and support it so it will not close once the original struts are removed. You can support it with a prop rod or similar tool, or even easier, enlist the help of a friend.

CAUTION

The hatch will not stay open with only one strut. The hatch must be supported at all times during this installation.

Step 2: Small flat blade screwdriver

Remove both original struts by prying out the spring retaining clips at the top and bottom, then pulling the strut ends off of the original ball studs.



HATCH POP KIT INSTALLATION

Step 3: T30 Torx Socket, 3/8 Ratchet

Remove the original ball stud body brackets on each side by removing the two mounting bolts (arrows) for each one. Note the position of the ball stud (highlighted).

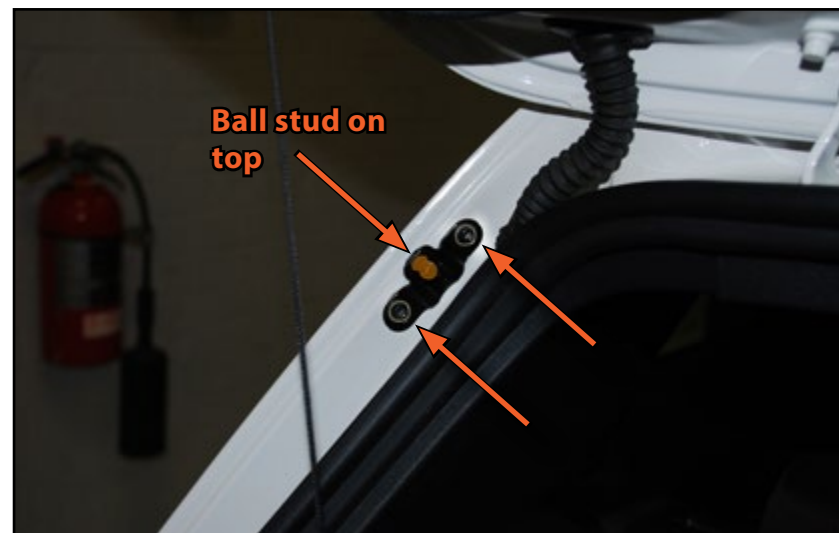

Step 4: T30 Torx Socket, 3/8 Ratchet

Flip each bracket over so the ball stud is located at the bottom, then install and tighten the mounting bolts.



HATCH POP KIT INSTALLATION

Step 5: 13mm Deep Socket, 3/8 Ratchet

Remove the original ball studs from the hatch.



Step 6: 13mm Deep Socket, 3/8 Ratchet

Install and tighten the new shorter ball studs on each side, making sure to place one of the new washers under each ball stud.



HATCH POP KIT INSTALLATION

Step 7:

The lower ball socket of each new strut has a wire clip retainer. Remove the wire clip from each ball socket using the pictures on the right as a guide.

A: The clip in its completely installed position.

B: Pivot the wire clip out of the groove at then end of the ball socket.

C: Pull the wire clip out of the two locating holes in the ball socket.

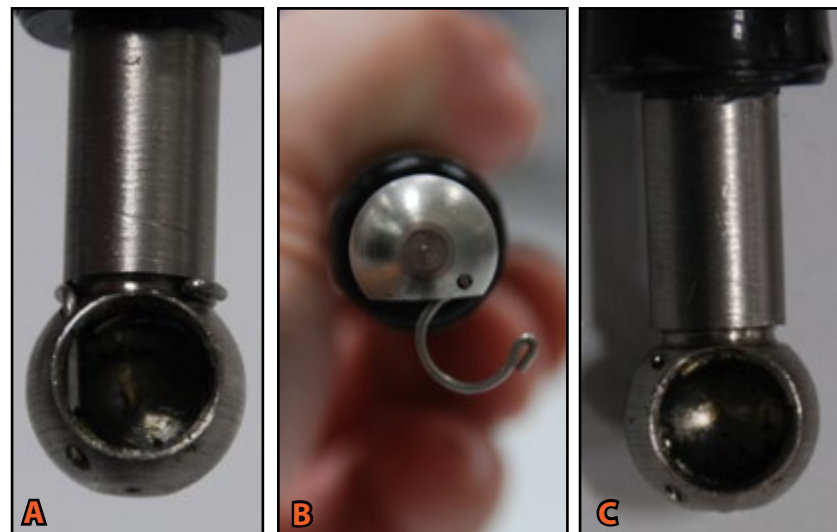

Step 8:

Push the lower ball socket of each new strut onto the ball stud body brackets, then install the wire clips previously removed in step seven.



HATCH POP KIT INSTALLATION

Step 9:

Push the upper end of each new strut into place on the new shorter ball studs located on the hatch.

NOTE

It is not necessary to remove the retaining clips to install the upper ends of the new struts.



Step 10:

Close the hatch, push the button, and enjoy!



Your MK6 Golf/GTI/Golf R Hatch Pop Kit installation is complete!



These instructions are provided as a courtesy by ECS Tuning.

Proper service and repair procedures are vital to the safe, reliable operation of all motor vehicles as well as the personal safety of those performing the repairs. Standard safety procedures and precautions (including use of safety goggles and proper tools and equipment) should be followed at all times to eliminate the possibility of personal injury or improper service which could damage the vehicle or compromise its safety.

Although this material has been prepared with the intent to provide reliable information, no warranty (express or implied) is made as to its accuracy or completeness. Neither is any liability assumed for loss or damage resulting from reliance on this material. SPECIFICALLY, NO WARRANTY OF MERCHANTABILITY, FITNESS FOR A PARTICULAR PURPOSE OR ANY OTHER WARRANTY IS MADE OR TO BE IMPLIED WITH RESPECT TO THIS MATERIAL. In no event will ECS Tuning, Incorporated or its affiliates be liable for any damages, direct or indirect, consequential or compensatory, arising out of the use of this material.