



Volkswagen MkV Golf/GTI/R32  
Hatch Pop Kit  
Installation Instructions



Proper service and repair procedures are vital to the safe, reliable operation of all motor vehicles as well as the personal safety of those performing the repairs. Standard safety procedures and precautions (including use of safety goggles and proper tools and equipment) should be followed at all times to eliminate the possibility of personal injury or improper service which could damage the vehicle or compromise its safety.

# INTRODUCTION

## ECS Tuning Volkswagen MkV Hatch Pop Kit ES#1895197

The ECS Tuning Volkswagen MkV Hatch Pop Kit offers the following features:

- Makes your hatch open completely with the push of a button
- Simple installation
- Complete with all necessary components
- Utilizes your original key fob

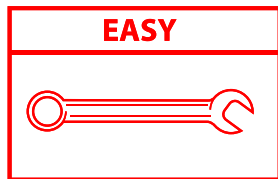

**BASIC SKILLS  
REQUIRED**

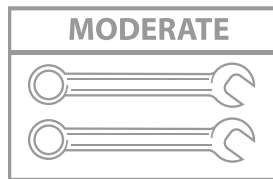

**SOME EXPERIENCE  
RECOMMENDED**

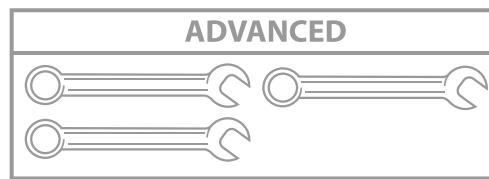

**ADVANCED SKILLS &  
EXPERIENCE REQUIRED**

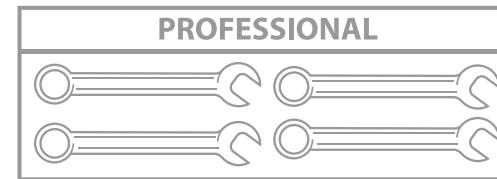

**PROFESSIONAL SKILLS &  
SPECIALTY TOOLS REQUIRED**

Installing the Volkswagen MkV Hatch Pop Kit is an easy afternoon project that you will be able to complete in about an hour, however VAG-COM coding is required. If you do not have access to VAG-COM diagnostic software, please consult a professional repair facility before beginning. These step by step instructions will provide you with a smooth, trouble free installation. Thank you for purchasing our ECS Tuning Volkswagen MkV Hatch Pop Kit. We appreciate your business!

## TABLE OF CONTENTS

Kit Contents..... pg.3  
Required Tools and Equipment..... pg.4  
Shop Supplies and Materials..... pg.4  
Installation Notes ..... pg.5  
Preparation and Safety..... pg.5  
Hatch Pop Kit Installation..... pg.6



Spring Loaded Stop Bumpers

## KIT CONTENTS



Ball Studs



Washers



Gas Struts

## REQUIRED TOOLS

Note: The tools required for each step will be listed by the step number throughout these instructions.

Below is a list of the tools we used to install the Volkswagen MkV Hatch Pop Kit. Additional tools may be required for any issues that arise during installation such as rust, corrosion, or broken and stripped fasteners.

- Flat Blade Screwdriver(s) ..... Available at [ecstuning.com](http://ecstuning.com).....[ES#2225921](#)
- 3/8" Sockets: 13mm Deep
- 3/8" Drive Ratchet
- Crescent Wrench
- 3mm Hex Bit Socket or Allen Wrench
- VAG-COM Diagnostic Software

## SHOP SUPPLIES AND MATERIALS

- Hand Cleaner/Degreaser..... Available at [ecstuning.com](http://ecstuning.com).....[ES#2167336](#)
- Shop Rags ..... Available at your local auto parts store
- Aerosol Spray Lubricant/Penetrating Oil..... Available at your local auto parts store

## INSTALLATION NOTES

- RH refers to the passenger side of the vehicle.
- LH refers to the driver side of the vehicle.
- Always use the proper torque specifications.
- If applicable to this installation, torque specifications will be listed throughout the document and at the end as well.
- Please read all of these instructions and familiarize yourself with the complete process before you begin.

## GENERAL PREPARATION AND SAFETY INFORMATION

ECS Tuning cares about your health and safety. Please read the following safety information. This information pertains to automotive service in general, and while it may not pertain to every job you do, please remember and share these important safety tips.

- Park your car in a safe, well lit, level area.
- Shut the engine off and remove the key from the ignition switch.
- Make sure any remote start devices are properly disabled.
- Always wear safety glasses.
- Make sure the parking brake is applied until the vehicle is safely lifted and supported.
- If using an automotive lift, be sure and utilize the factory specified lift points. Lifting a vehicle in an incorrect location can cause damage to the suspension/running gear.
- When lifting a vehicle using a jack, always utilize the factory specified lift points. Lifting a vehicle in an incorrect location can cause damage to the suspension/running gear. Always support the vehicle with jack stands.
- Always read and follow all safety information and warnings for the equipment you are using.



Never get underneath a vehicle that is supported only by a jack. Always make sure that the vehicle is securely supported on jack stands.

## HATCH POP KIT INSTALLATION

### Step 1:

Open the rear hatch and support it so it will not close once the original struts are removed. You can support it with a prop rod or similar tool, or even easier, enlist the help of a friend.

#### CAUTION

The hatch will not stay open with only one strut. The hatch must be supported at all times during this installation.

### Step 2: Small flat blade screwdriver

Remove both original struts by prying out the retaining clips at the top and bottom, then pulling the strut ends off of the original ball studs.



## HATCH POP KIT INSTALLATION

**Step 3:** 13mm Deep Socket, 3/8 Ratchet

Remove both of the original long ball studs on the hatch.



**Step 4:** 13mm Deep Socket, 3/8 Ratchet

Install both of the new shorter ball studs on the hatch, making sure to place one of the new washers on each ball stud before installing it.



## HATCH POP KIT INSTALLATION

### Step 5:

The lower ball socket of each new strut has a wire clip retainer. Remove the wire clip from each ball socket using the pictures on the right as a guide.

- A: The clip in its completely installed position.
- B: Pivot the wire clip out of the groove at then end of the ball socket.
- C: Pull the wire clip out of the two locating holes in the ball socket.

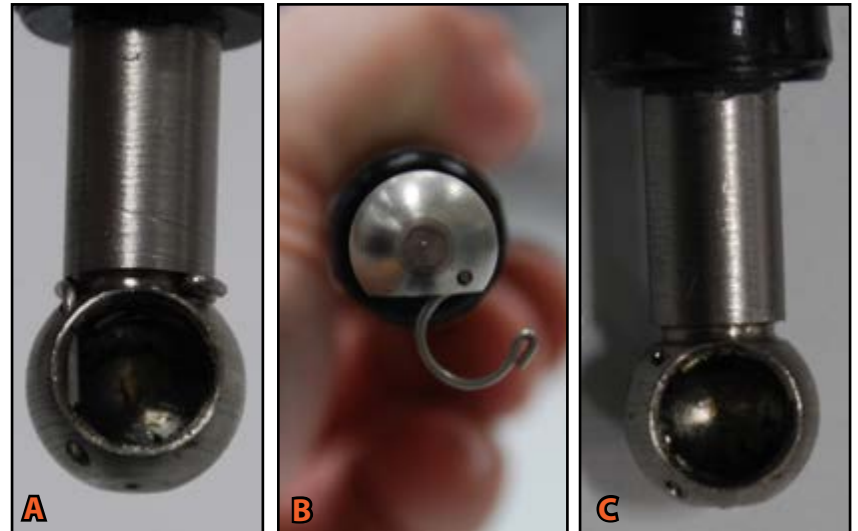

### Step 6:

Push the lower ball socket of each new strut onto the ball stud at the body, then install the wire clips previously removed in step five.





## HATCH POP KIT INSTALLATION

### Step 7:

Push the upper end of each new strut into place on the new shorter ball studs located on the hatch.

#### NOTE

It is not necessary to remove the retaining clips to install the upper ends of the new struts.



### Step 8: Crescent Wrench

Remove the two original hatch bumpers by twisting them counter clockwise one quarter turn then pulling them straight out.

#### NOTE

You may be able to turn the bumpers out by hand. Use a wrench only if they are stuck in place.



## HATCH POP KIT INSTALLATION

### Step 9:

Unpack the new spring loaded bumpers. They should look like the picture on the left with the spring locked in the compressed position. If they look like this, then skip to step 11. If the spring is released as shown in the picture on the right, then continue with step 10.

**NOTE**

We recommend reading through step 17 to familiarize yourself with the spring bumper installation before proceeding.

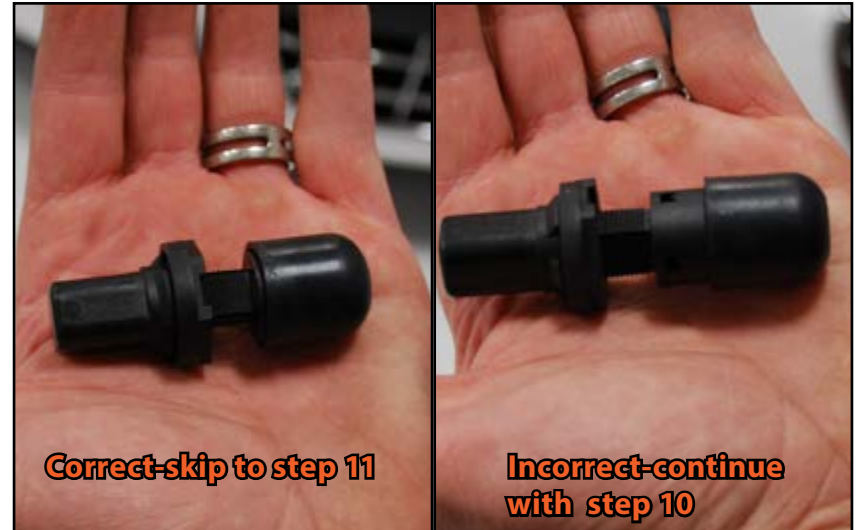

### Step 10:

Push the bumper cap until the spring is compressed, then turn it clockwise approximately one quarter turn until the cap is locked with the spring in the compressed position (reference the LH picture in step nine).



## HATCH POP KIT INSTALLATION

### Step 11: Crescent Wrench

Install the two new bumpers into the hatch by pushing them in then turning them one quarter turn clockwise.

#### NOTE

Use a wrench only for light assistance in turning the new bumpers. Do not continue to put force on these once they stop turning.



### Step 12: 3mm Hex Bit

Insert a 3mm hex bit into the center of each new bumper until it engages the small screw inside, then loosen the screw approximately three complete turns. You will be able to see that the bumpers are loose and you can wiggle them back and forth.



## HATCH POP KIT INSTALLATION

### Step 13:

Note the position of the spring bumpers. The depth of these bumpers is adjustable. The bumpers will be extended as shown in the picture. Also note the number of teeth that are exposed on the main shaft of each bumper (arrow).



### Step 14:

Completely close, but DO NOT SLAM the hatch. Reopen the hatch and the bumpers will have adjusted themselves to the correct position. Note in this picture how the main shaft of the bumper has been pushed in and there are fewer teeth visible.



**NOTE**

The amount of adjustment may vary depending on a number of factors including hatch fitment, bump stop condition etc.

## HATCH POP KIT INSTALLATION

### Step 15: 3mm Hex Bit

Tighten the 3mm screw in the center of each spring bumper. This will secure the bumper in the adjusted position.



### Step 16:

Grasp each bumper cap and turn it counter clockwise.



## HATCH POP KIT INSTALLATION

### Step 17:

The bumper caps will release and extend as shown in the picture. They are now completely adjusted and ready for use.



### Step 18: VAG-COM

Connect the VAG-COM Diagnostic connector to the OBDII port in your car.



## HATCH POP KIT INSTALLATION

### Step 19: VAG-COM

Reprogram the hatch lock function using the following guidelines:

Central Convenience-46

Coding-07

Long Coding Helper

Copy and paste your stock coding as a precautionary measure

Click BYTE#2 (This is the third byte from the left)

Check box Bit#3 Central Locking (Rear Lid) Soft Touch  
(Direct open/no release)

Close that window

Click "Do it"



### Step 20:

Disconnect VAG-COM, close the hatch, push the button, and enjoy!



Your MkV Golf/GTI/R32 Hatch Pop Kit installation is complete!



These instructions are provided as a courtesy by ECS Tuning.

Proper service and repair procedures are vital to the safe, reliable operation of all motor vehicles as well as the personal safety of those performing the repairs. Standard safety procedures and precautions (including use of safety goggles and proper tools and equipment) should be followed at all times to eliminate the possibility of personal injury or improper service which could damage the vehicle or compromise its safety.

Although this material has been prepared with the intent to provide reliable information, no warranty (express or implied) is made as to its accuracy or completeness. Neither is any liability assumed for loss or damage resulting from reliance on this material. SPECIFICALLY, NO WARRANTY OF MERCHANTABILITY, FITNESS FOR A PARTICULAR PURPOSE OR ANY OTHER WARRANTY IS MADE OR TO BE IMPLIED WITH RESPECT TO THIS MATERIAL. In no event will ECS Tuning, Incorporated or its affiliates be liable for any damages, direct or indirect, consequential or compensatory, arising out of the use of this material.