



Section 1: Installation

1. The ECS carbon fiber fuse box cover is designed to fit directly on top of the OEM fuse box lid, it features a "wing" which covers the ECU. The CF cover only fits one way, note the orientation shown in the **Step 1** photo below.
 - The CF cover can be installed with the OEM lid in the vehicle, but it is easier to do off the vehicle, the choice is yours.
 - Be sure to thoroughly clean the top and sides of the OEM lid before moving on to the next step.
2. Perform the following steps on the ECS carbon fiber fuse box cover:
 - Completely remove the protective backing from the SHORT length pieces of double-sided tape (pointed out with arrows in the **Step 2** photo below).
 - Partially remove the protective backing from the LONG pieces of double-sided tape. Ensure that these "ears" will be accessible while installing the CF cover into place (we will remove these later).
3. Align the CF fuse box cover to the OEM lid, ensure that the double-sided tape "ears" are sticking out between them, then:
 - Push the LH edge of the CF cover against the OEM lid (shown in the **Step 3a** photo below).
 - Pivot the CF cover downward onto the OEM lid while gently spreading the CF cover apart to prevent the small pieces of double-sided tape from adhering too early (shown in the **Step 3b** photo below).

Step 1



Step 2

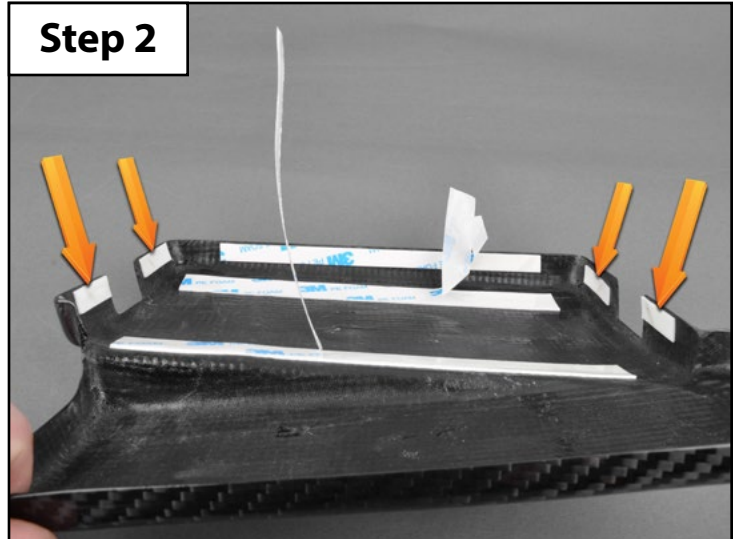

Step 3a



Step 3b

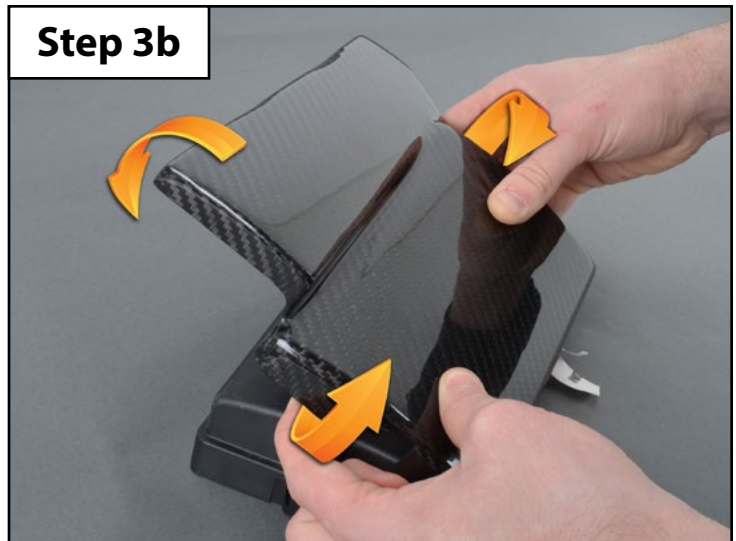

Section 1: Installation (continued)

4. Remove the protective backing from the double-sided tape once the CF cover has been fully seated into place.
5. Reinstall the fuse box cover into the vehicle if you removed it in step 1, ensuring that both retaining clips “snap” into place (arrows in the Step 5 photo below).

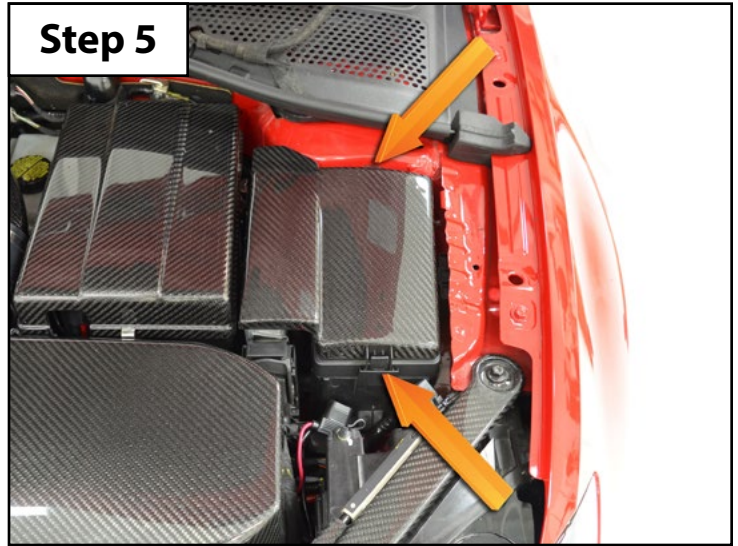
Step 4**Step 5**

Section 2: Carbon Fiber Cleaning & Care

ECS Tuning Carbon Fiber products are clear coated for excellent finish durability and UV resistance right out of the box. Carbon fiber can be washed with any gentle cleanser or soap. If it is safe for the paint on your car, it will be safe for the carbon fiber. Be extra careful not to nick or deeply scratch the clear coat on the carbon fiber. This can lead to water intrusion into the carbon fiber which will damage the finish and the integrity of the component.

If the clear coat does get nicked or deeply scratched to expose the carbon fiber, seal the damaged area thoroughly with a clear coat touch up or clear nail polish. To retain UV resistance and protect the finish, we recommend regular waxing with a high quality caranuba wax. Small surface scratches and light oxidation can be buffed out using the same methods and cautions you would use on the vehicle paint.

