

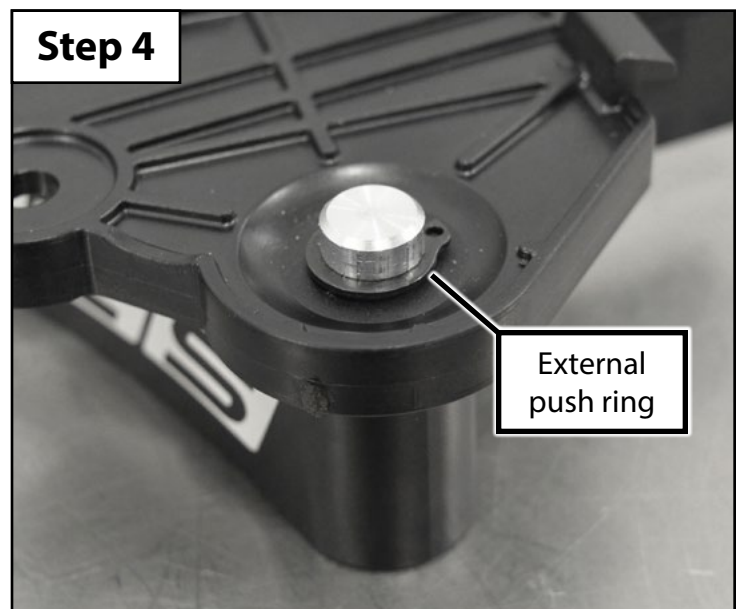

## Audi B6/B7 Billet Interior Hood Release Lever Installation Instructions - ES3426571

1. Remove the OEM hood release lever assembly from the vehicle (not shown). Note the location of the external push ring in the step 1 photo below, this is what retains the lever in the bracket.
2. Using a pick or suitable tool, remove the external push ring by prying up on the fingers that lock it in place, then sliding it off.
3. Remove the OEM hood release lever from the bracket.
4. Install the billet release lever into the bracket (not shown), then install the provided external snap ring into the groove in the lever, making sure that the ring is fully seated.
  - **NOTE:** Do not over extend the snap ring while installing it, these clips will yield easily when too much force is applied and lose their clamping force. If your does yield, try removing it, gently squeezing it inward, and reinstalling it.
5. Reinstall the lever assembly into the vehicle in the reverse order of removal (not shown).

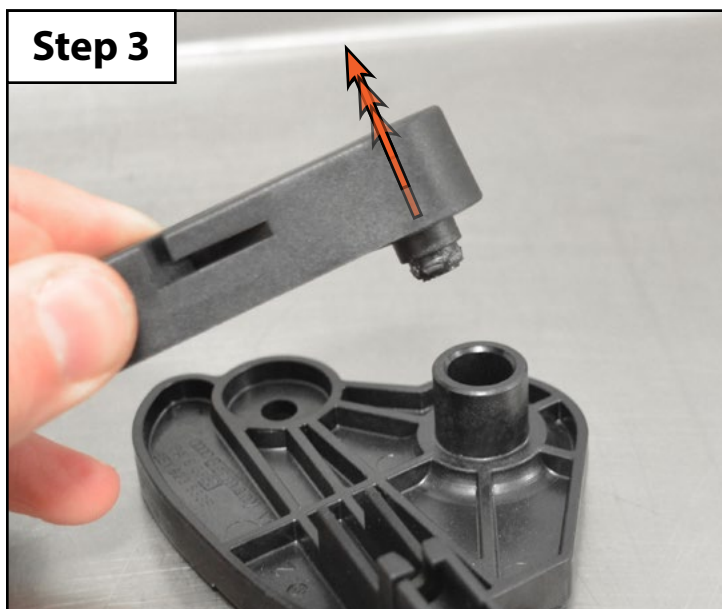
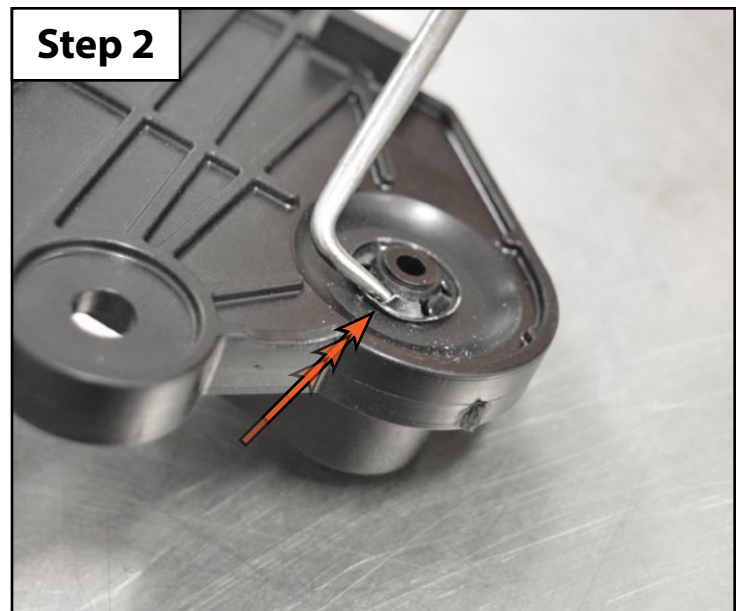
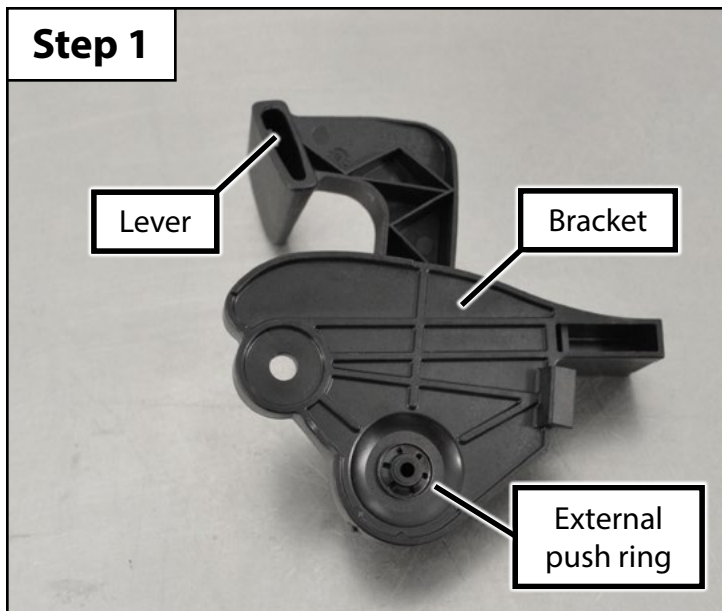

Proper service and repair procedures are vital to the safe, reliable operation of all motor vehicles as well as the personal safety of those performing the repairs. Standard safety procedures and precautions (including use of safety goggles and proper tools and equipment) should be followed at all times to eliminate the possibility of personal injury or improper service which could damage the vehicle or compromise its safety.