

Section 1: Transferring the Pressure Relief Valve

- #1a: Remove the stock coolant reservoir cap (**Photo #1a**). Use a hose pick to carefully pry the pressure relief valve out of the four clips which secure it into the cap. Reference the **YELLOW** inset photo, you want to try and get the pick flat up against the back side of the valve to prevent cracking it during removal.
- #1b: We've found that the larger picks work better than the small ones for this (**Photo #1b**). Our Schwaben hose pick set can be found on our site by clicking [HERE](#).
- #2: Align the pressure relief valve with the clips in the new cap and push it downward until it clicks into place (**Photo #1c**).

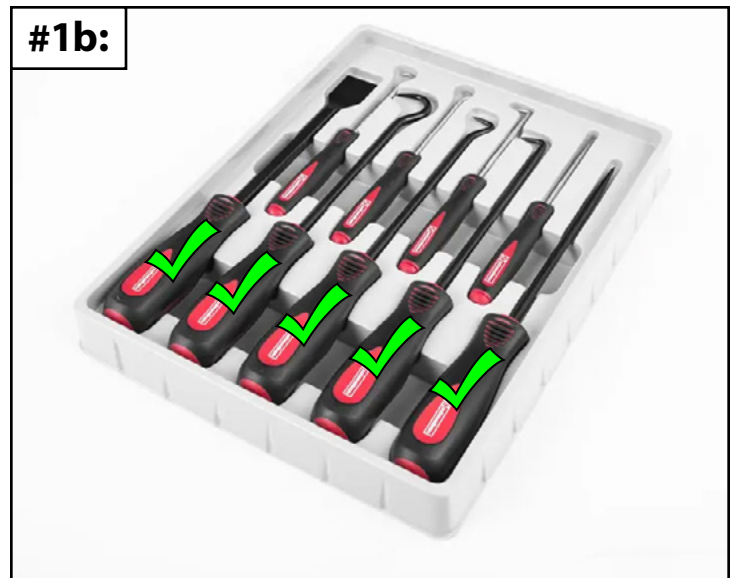

Proper service and repair procedures are vital to the safe, reliable operation of all motor vehicles as well as the personal safety of those performing the repairs. Standard safety procedures and precautions (including use of safety goggles and proper tools and equipment) should be followed at all times to eliminate the possibility of personal injury or improper service which could damage the vehicle or compromise its safety.

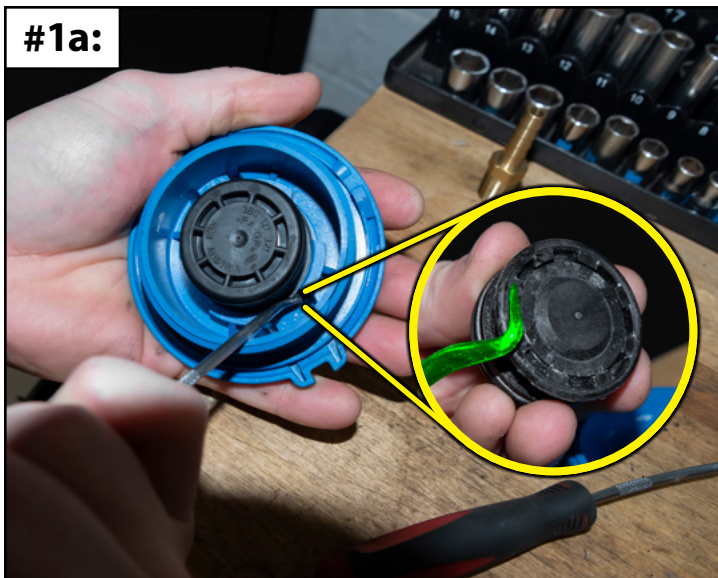

Skill Level 1:
Easy