



**Thank you for purchasing your new ECS Tuning
Adjustable Clutch Pedal Stop, we appreciate your business!**



Project Overview:

It's no secret that the clutch pedal found in the Audi B8 will leave a large amount of "dead space" behind the clutch engagement. This means that you can push the pedal far beyond where the clutch disengages when starting your vehicle or shifting gears. We are excited to announce that the engineering team at ECS Tuning has designed a quick and easy solution for this problem. Our new adjustable pedal stop will eliminate this unnecessary pedal travel, while also offering a more sporty pedal feel and quicker shifts.

For better clarity we took some of the photos with the clutch pedal removed from the vehicle, but you won't need to go that far.

Installation is fast and only requires a few basic hand tools. Installation and adjustment can be performed in just a few minutes (depending on your experience level). Be sure to read these instructions carefully and completely before you begin.

These installation instructions have been broken up into sections:

1) Installing the Adjustable Clutch Pedal Stop

[\(Page 2\)](#)

2) Adjusting the New Clutch Pedal Stop

[\(Page 3\)](#)

Section 2: Installing the Adjustable Clutch Pedal Stop

- Step #1** • Locate the OE clutch pedal stop on the back side of the clutch pedal (**photo #1**).
- Step #2** • Gently pry the clip back to release it, then slide the pedal stop out of the clutch pedal (**photo #2**).
- Step #3** • Slide the new adapter plate into the back of the clutch pedal (**photo #3**).
• Use a 2mm hex key to tighten the set screw in the adapter plate until it makes contact + 1/8 turn.
- Step #4** • Thread the adjustable clutch pedal stop and the jam nut into the adapter by hand (**photo #4**).
- Proceed to [Page 3](#) for adjustment instructions.

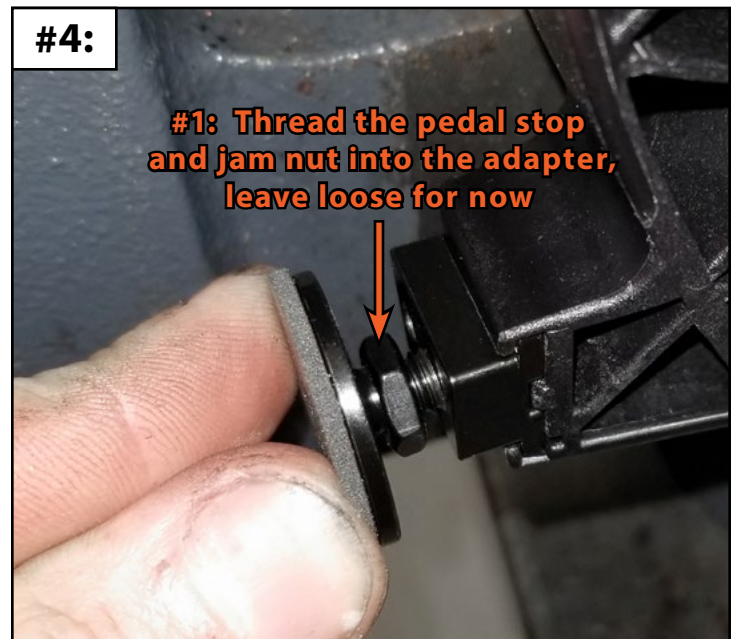
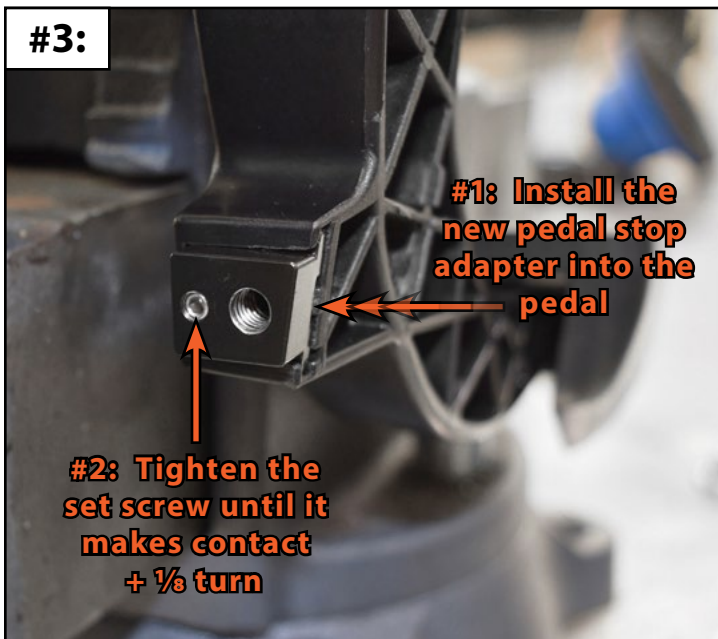
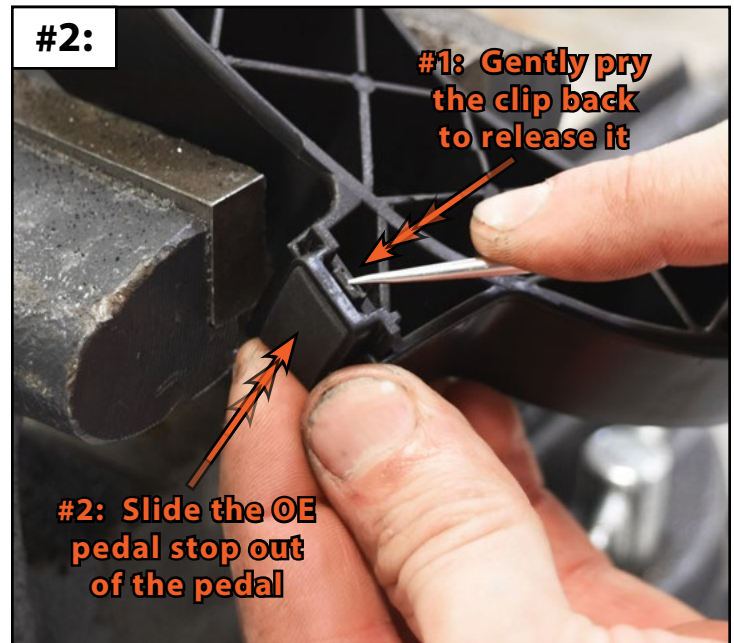
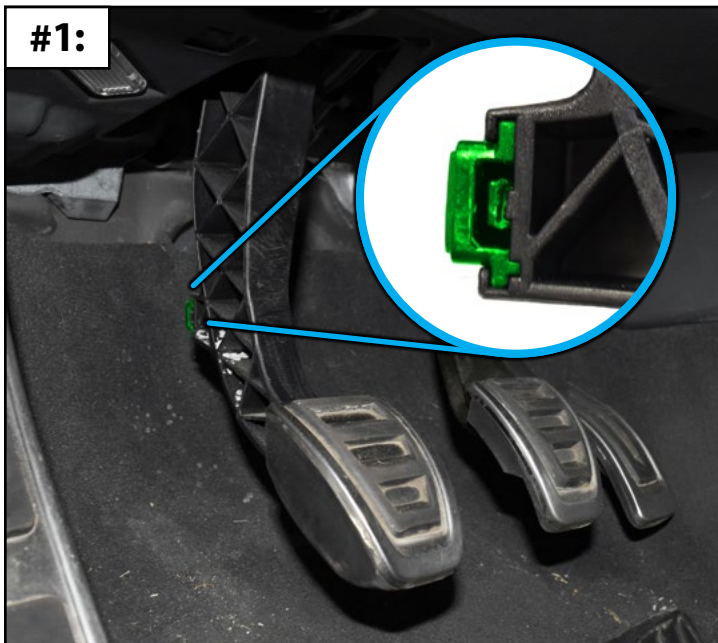

Section 3: Adjusting the New Clutch Pedal Stop

Step #1

- Use the illustration below as a reference. We are looking to split the difference between where the clutch pedal would bottom out against the OEM rubber bumper (highlighted in **RED**), and the clutch pedal engagement height (highlighted in **GREEN**).
- We recommend starting the adjustment down low, then working your way up.
 - Starting with the jam nut and pedal stop all the way bottomed out against the pedal, you will have approximately 4x full rotations worth of adjustment room (anything more than 4x rotations can make the stud feel unstable and we don't recommend it).
 - We found that when we rotated out pedal stop out 2x full rotations we got the pedal feel we were looking for.
- The clutch pedal stop must be adjusted to allow for the following:
 - ❗ 1. The pedal **MUST** be able to travel downward far enough in order to engage the clutch safety switch and allow the vehicle to start.
 - ❗ 2. The pedal **MUST** be able to travel downward far enough to allow the clutch to fully disengage, preventing difficult shifting, or possible damage to the clutch/transmission.
- Once you have adjusted the clutch pedal stop to your liking, tighten the 10mm jam nut until it is snug.

