

## Universal Vacuum Formed ABS Component Installation Instructions



**Thank you for purchasing your vacuum formed ABS component  
from ECS Tuning, we appreciate your business!**



### Sleek Design

- Each component is constructed of sleek and subtle vacuum formed ABS plastic.
- Components feature a high gloss finish.



### Precision Engineering:

- Each component is designed by our engineers to contour to the natural lines of the vehicle.
- Each Component is designed to accentuate the vehicle's styling to provide an aggressive yet tasteful look.



### Superior Fitment:

- Each component is designed in-house using state-of-the-art equipment to ensure superior fitment.
- Components feature OE style mounting tabs and hardware for a seamless installation.

## Section 1: Installing the ABS Component

- Step 1** • Start by thoroughly washing and drying the entire mounting surface area of the vehicle. Then, prep the surface by wiping it down with isopropyl alcohol and a microfiber cloth.
- Step 2** • Next we'll perform a quick test fit WITHOUT removing the backing from the double sided tape to ensure proper orientation and fitment.
- Step 3** • Now we're ready to install the ABS component.
- Start by peeling 1-2 inches of backing off of the double sided tape and folding it over to the side (as shown in photo #3).
  - The goal here is to "dog ear" the backing strip so we can pull it out after the component is correctly laid in place.
- Step 4** • Carefully lay the ABS component into place on the vehicle, ensuring that it is located and aligned properly.
- Pull each strip back so that the adhesive makes contact with the vehicle, holding it in place.
  - Don't fully remove the backing yet!

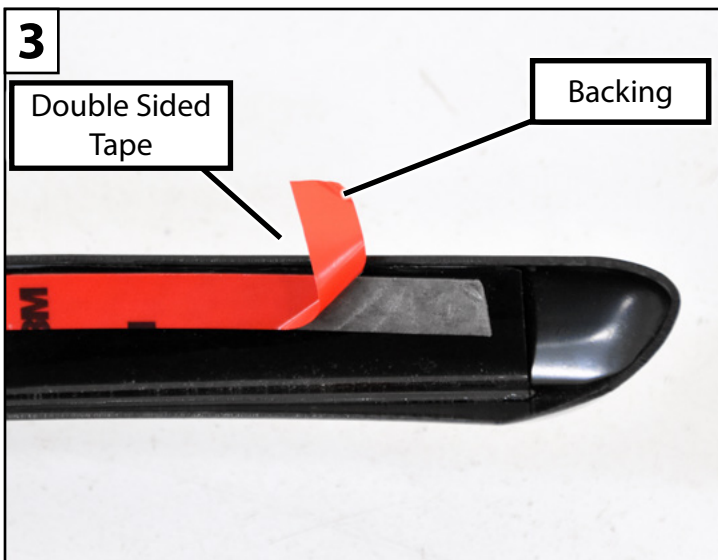



## Section 1: Installing the ABS Component

- Step 5** • Firmly push downward on the ABS component to hold it in place while slowly pulling the backing strip out.
- Take your time here, a little patience can help you to avoid accidentally tearing the backing strip, or causing the double sided tape to not fully adhere to the vehicle.
- Step 6** • Push down along the entire mounting area of the component once the backing strip has been removed to ensure that all the tape fully adheres to the vehicle.
- Step 7** • Carefully remove the clear protective film from the component to reveal the gloss finish.
- Step 8** • To help keep your ABS component looking like new, we highly recommend investing in a high-quality trim protectant. A quality trim protectant will help protect the deep glossy finish and prevent scratches and fading, keeping your ABS component looking sharp for years to come.



## Section 2: Removing Scratches

- Step 1**
- Over time road debris, car washes, and contaminants can cause tiny scratches and swirls to form, detracting from the glossy finish on your new ABS component.
  - If this happens, we highly recommend using an abrasive cutting or polishing compound to smooth out any scratches and restore the glossy finish.
  - Before removing scratches be sure to thoroughly wash and dry the ABS component to remove any contamination.
- Step 2**
- Using the cutting compound of your choice and a clean microfiber cloth, polish away the scratches, then buff off any leftover product leaving behind a consistent and smooth glossy finish.
  - Once any scratches are removed and you are happy with your finish, we highly recommend re-applying a high-quality plastic trim protectant to protect all your hard work.

