



## VW Atlas VR6 Luft-Technik Intake System Installation Instructions - [ES4004563](#)



**Skill Level**  
**1 - Easy**  
**Basic Skills**  
**Required**



Proper service and repair procedures are vital to the safe, reliable operation of all motor vehicles as well as the personal safety of those performing the repairs. Standard safety procedures and precautions (including use of safety goggles and proper tools and equipment) should be followed at all times to eliminate the possibility of personal injury or improper service which could damage the vehicle or compromise its safety.

## TABLE OF CONTENTS

Required Tools and Equipment.....	<a href="#">pg.3</a>
Installation and Safety Information.....	<a href="#">pg.4</a>
Removing the Stock Intake System.....	<a href="#">pg.5</a>
Installing the New Intake System.....	<a href="#">pg.8</a>

## KIT CONTENTS



Air Box



Intake Hose



Air Filter



Mounting Bracket



Hardware Pack

## REQUIRED TOOLS

Note: The tools required for each step will be listed by the step number throughout these instructions.

### Standard Automotive Tools

- Protecta-Sockets (for lug nuts)..... [ES#2221243](#)
- $\frac{3}{8}$ " Drive Ratchet..... [ES#2765902](#)
- $\frac{3}{8}$ " Drive Torque Wrench..... [ES#2221245](#)
- $\frac{3}{8}$ " Drive Deep and Shallow Sockets..... [ES#2763772](#)
- $\frac{3}{8}$ " Drive Extensions ..... [ES#2804822](#)
- Hydraulic Floor Jack ..... [ES#2834951](#)
- **Torx Drivers and Sockets** ..... [ES#11417/8](#)
- $\frac{1}{2}$ " Drive Deep and Shallow Sockets..... [ES#2839106](#)
- $\frac{1}{2}$ " Drive Ratchet
- $\frac{1}{2}$ " Drive Extensions
- $\frac{1}{2}$ " Drive Torque Wrench..... [ES#2221244](#)
- $\frac{1}{2}$ " Drive Breaker Bar ..... [ES#2776653](#)
- Bench Mounted Vise
- Crows Foot Wrenches
- Hook and Pick Tool Set ..... [ES#2778980](#)

### Required For This Install

### Available On Our Website

- **$\frac{1}{4}$ " Drive Ratchet**..... [ES#2823235](#)
- **$\frac{1}{4}$ " Drive Deep and Shallow Sockets**..... [ES#2823235](#)
- **$\frac{1}{4}$ " Drive Extensions**..... [ES#2823235](#)
- Plier and Cutter Set..... [ES#2804496](#)
- Flat and Phillips Screwdrivers ..... [ES#2225921](#)
- Jack Stands..... [ES#2763355](#)
- Ball Pein Hammers
- Pry Bar Set..... [ES#1899378](#)
- Electric/Cordless Drill
- Wire Strippers/Crimpers
- Drill Bits
- Punch and Chisel Set
- **Hex Bit (Allen) Wrenches and Sockets** ..... [ES#11420](#)
- Thread Repair Tools ..... [ES#1306824](#)
- **Open/Boxed End Wrench Set**..... [ES#2765907](#)

## INSTALLATION NOTES

- **RH** refers to the *passenger side* of the vehicle.
- **LH** refers to the *driver side* of the vehicle.
- Always use the proper torque specifications.
- If applicable to this installation, torque specifications will be listed throughout the document and at the end as well.
- Please read all of these instructions and familiarize yourself with the complete process **BEFORE** you begin.

## GENERAL PREPARATION AND SAFETY INFORMATION

ECS Tuning cares about your health and safety, please read the following safety information. This information pertains to automotive service in general, and while it may not pertain to every job you do, please remember and share these important safety tips.

- Park your car in a safe, well lit, level area.
- Shut the engine off and remove the key from the ignition switch.
- Make sure any remote start devices are properly disabled.
- **ALWAYS** wear safety glasses.
- Make sure the parking brake is applied until the vehicle is safely lifted and supported.
- Whether lifting a vehicle using an automotive lift or a hydraulic jack, be sure and utilize the factory specified lift points.
- Lifting a vehicle in an incorrect location can cause damage to the suspension/running gear.
- **ALWAYS** support the vehicle with jack stands.
- **ALWAYS** read and follow all safety information and warnings for the equipment you are using.



**NEVER** get underneath a vehicle that is supported only by a jack, and **ALWAYS** make sure that the vehicle is securely supported on jack stands.

## REMOVING THE STOCK INTAKE SYSTEM

### Step 1:

Pull back on the locking tab on the MAF sensor connector (highlighted in **RED**) then disconnect it from the MAF.



### Step 2: Flat Head Screwdriver -OR- 8mm Socket & Ratchet

Loosen the hose clamps (arrows) which secure the factory intake pipe, then pull it free from the vehicle.

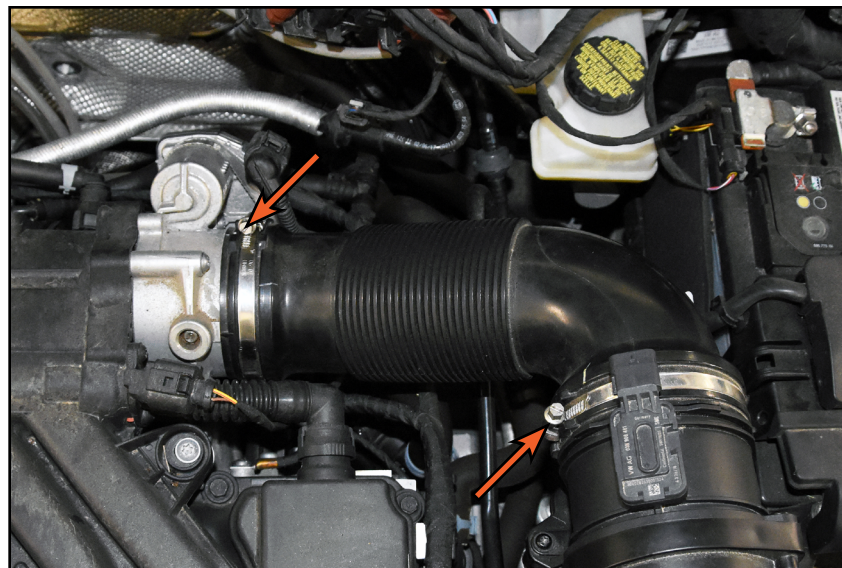

## REMOVING THE STOCK INTAKE SYSTEM

### Step 3: T25 Torx

Remove the two screws (arrows) from the inlet duct, then push down on the duct to free it from the core support.

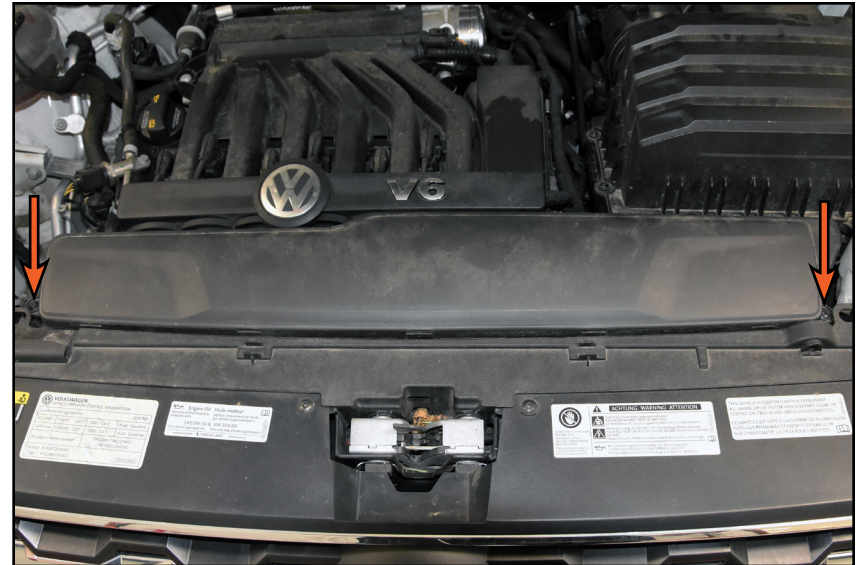

### Step 4:

Slide the inlet scoop rearward, rotate it out from the core support, and remove it as shown.



## REMOVING THE STOCK INTAKE SYSTEM

### Step 5:

Pull up on the factory air box to pop it free from its mounting grommets, then carefully remove it from the engine.

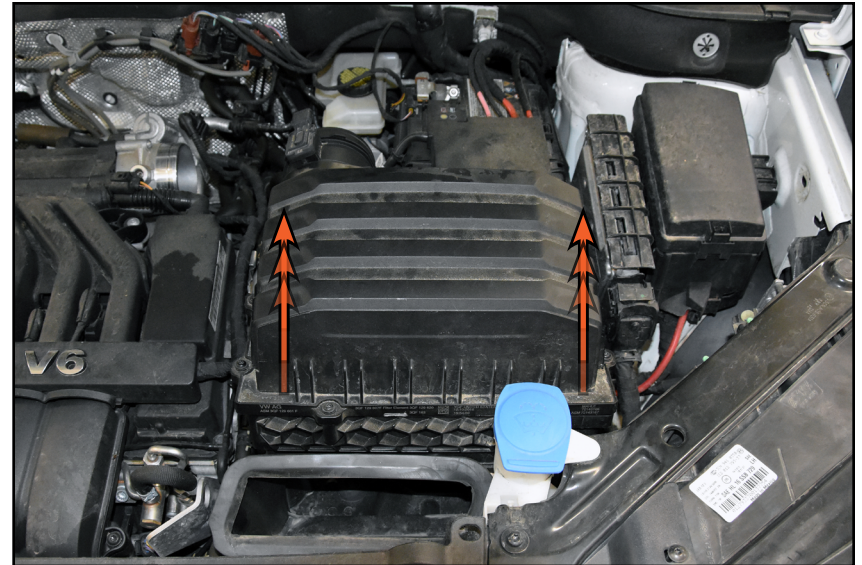

### Step 6: T25 Torx

Remove the two screws (arrows) which secure the MAF to the back of the air box. Carefully pull the MAF free and set it aside.

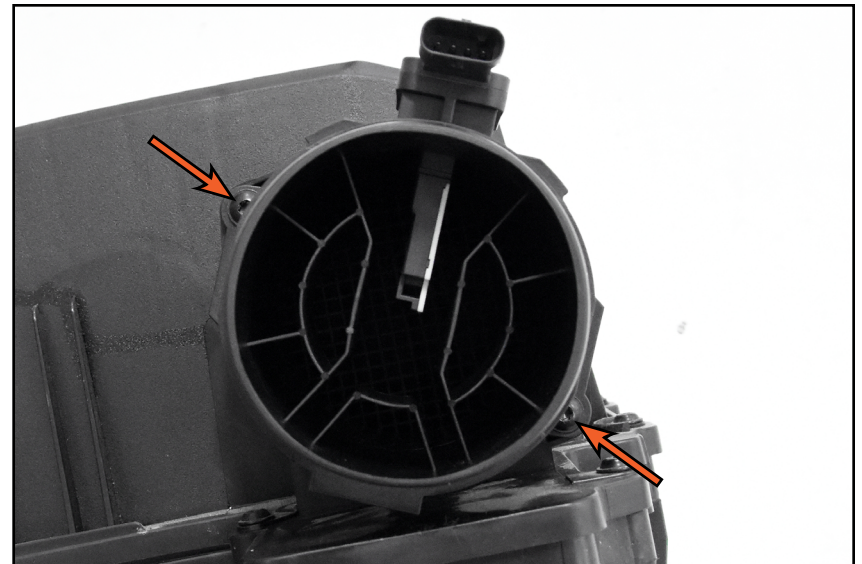

## INSTALLING THE NEW INTAKE SYSTEM

### Step 1: 4mm Hex (Allen)

Install the mounting bracket onto the new air box by sliding the included hardware through the two slotted holes on the lower part of the air box as shown. Tighten the screws (arrows) until they make contact then give them an additional ¼ turn.

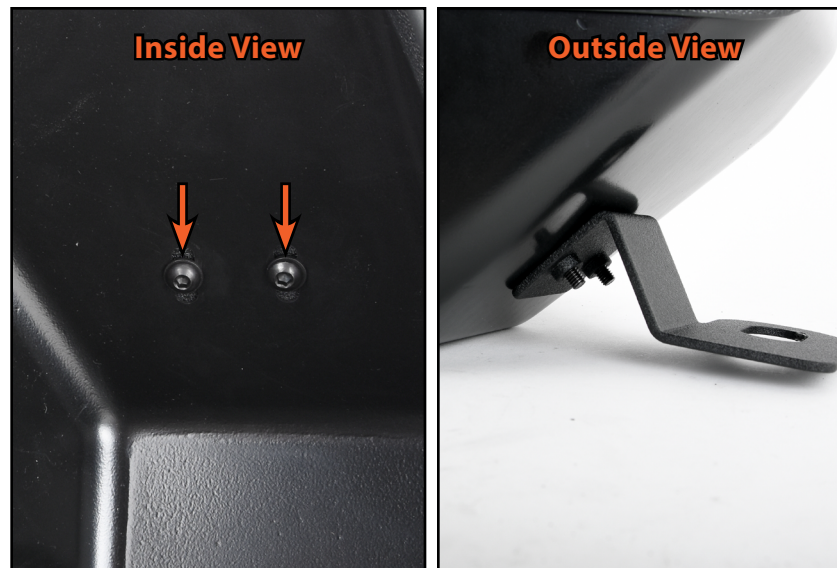

### Step 2:

Install the two provided grommets (highlighted in **GREEN**) into the openings on the bottom of the air box and the mounting bracket as shown.



## INSTALLING THE NEW INTAKE SYSTEM

### Step 3: 10mm Wrench, 4mm Hex (Allen)

Slide the MAF sensor through the large opening in the back of the air box, then slide the provided screws and washers through the air box and MAF, threading on the nuts to secure the MAF in place. Tighten the nuts (arrows) until they make contact then give them an additional ¼ turn.

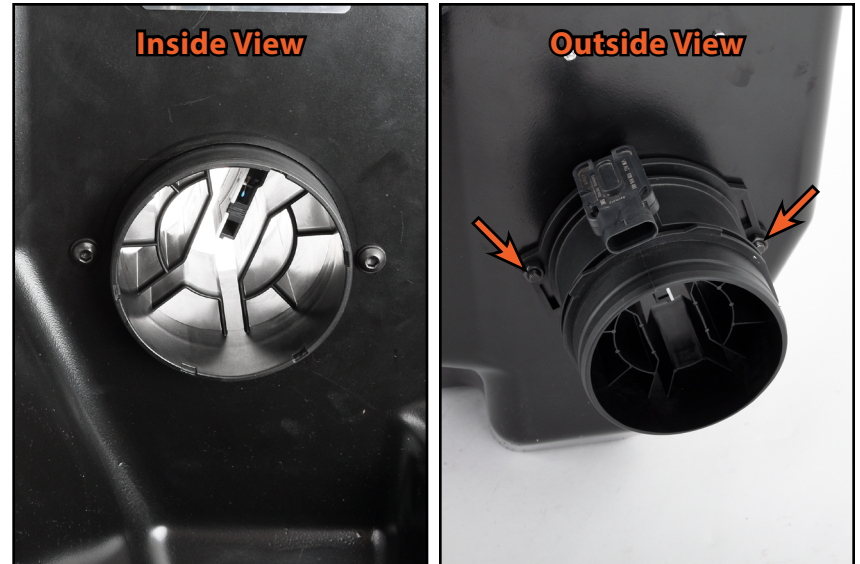

### Step 4:

Install the assembled air box into the vehicle, then align the two grommets on the air box with the posts on the vehicle and push down to pop them into place.

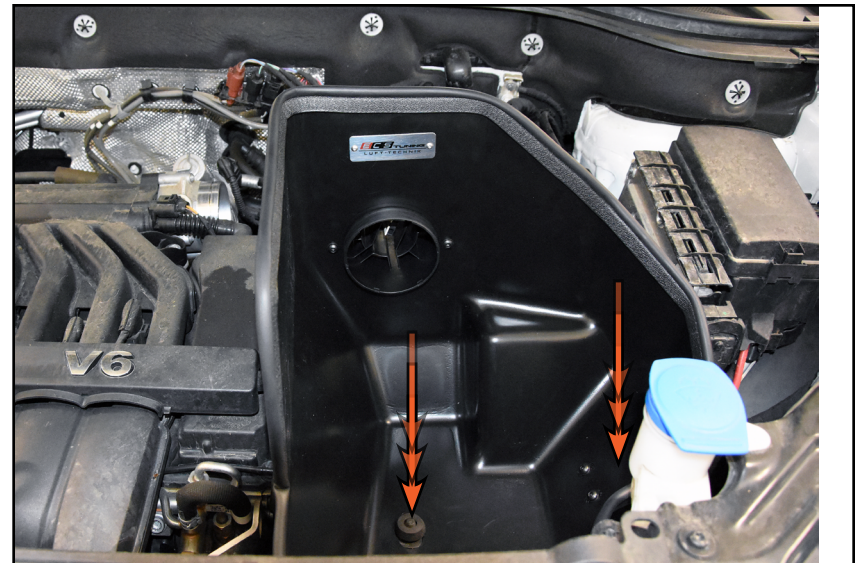

## INSTALLING THE NEW INTAKE SYSTEM

### Step 5: Flat Head Screwdriver -OR- 7mm Socket & Ratchet

Ensure that both hose clamps are properly in place then install the intake hose between the throttle body and MAF sensor and tighten the clamps (arrows) until snug.



### Step 6: T25 Torx

Slide the inlet duct back into the core support and reinstall the screws (arrows).



## INSTALLING THE NEW INTAKE SYSTEM

**Step 7:** Flat Head Screwdriver -OR- 8mm Socket & Ratchet

Slide the air filter onto the end of the MAF sensor and tighten the clamp (arrow) until snug to secure it in place.

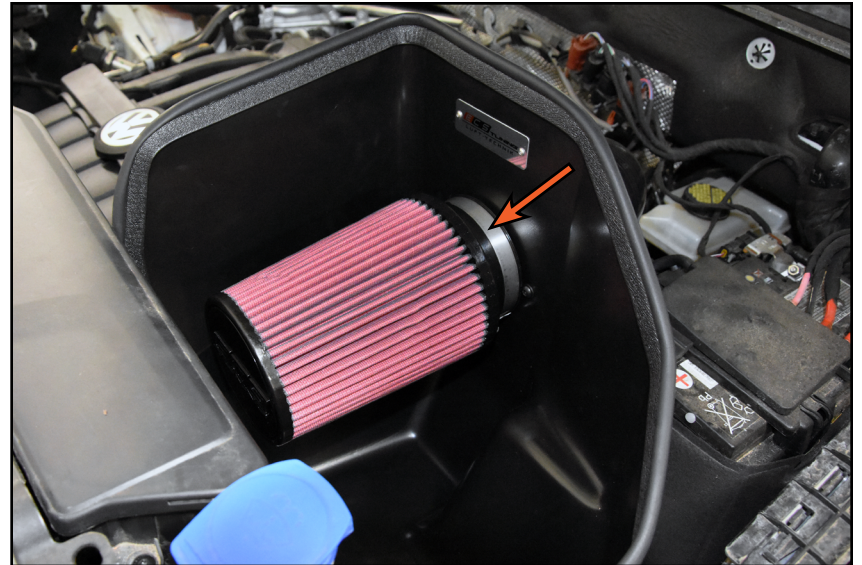

**Step 8:**

Reconnect the MAF sensor connector (highlighted in **GREEN**) and push the locking tab back into place.



***Congratulations, your installation is complete!***

**Your Luft-Technik Intake System installation is complete!**



**These instructions are provided as a courtesy by ECS Tuning**

Proper service and repair procedures are vital to the safe, reliable operation of all motor vehicles as well as the personal safety of those performing the repairs. Standard safety procedures and precautions (including use of safety goggles and proper tools and equipment) should be followed at all times to eliminate the possibility of personal injury or improper service which could damage the vehicle or compromise its safety.

Although this material has been prepared with the intent to provide reliable information, no warranty (express or implied) is made as to its accuracy or completeness. Neither is any liability assumed for loss or damage resulting from reliance on this material. SPECIFICALLY, NO WARRANTY OF MERCHANTABILITY, FITNESS FOR A PARTICULAR PURPOSE OR ANY OTHER WARRANTY IS MADE OR TO BE IMPLIED WITH RESPECT TO THIS MATERIAL. In no event will ECS Tuning, Incorporated or its affiliates be liable for any damages, direct or indirect, consequential or compensatory, arising out of the use of this material.