



Volkswagen Atlas Street Shield Skid Plate Installation Instructions - [ES4164547](#)



Skill Level
1 - Easy
Basic Skills
Required



Proper service and repair procedures are vital to the safe, reliable operation of all motor vehicles as well as the personal safety of those performing the repairs. Standard safety procedures and precautions (including use of safety goggles and proper tools and equipment) should be followed at all times to eliminate the possibility of personal injury or improper service which could damage the vehicle or compromise its safety.

INTRODUCTION

Today we're going to install our new Street Shield Skid Plate onto a Volkswagen Atlas. Our Street Shield skid plate has been specifically designed for this application to replace the flimsy, fragile OE belly pan. You'll only need a few basic tools (listed below the photo on the right) and around 30-60 minutes of your time to install this kit. We'll be working on a lift, but this job can easily be done on jack stands or ramps as long as the vehicle is safely supported.

Before you begin, read through these instructions and check the required tool list to make sure you have everything you need. Thank you for looking to ECS Tuning for all your performance and repair needs, we appreciate your business!



Tools required for this install:

1. T25 Torx Driver
2. T45 Torx Driver
3. 4mm Hex (Allen)
4. 5mm Hex (Allen)
5. Small Pick

TABLE OF CONTENTS

Kit Contents.....	pg.3
Installation and Safety Information.....	pg.4
Removing the Original Insulation Panel.....	pg.5
Installing the New Street Shield Skid Plate.....	pg.6

KIT CONTENTS

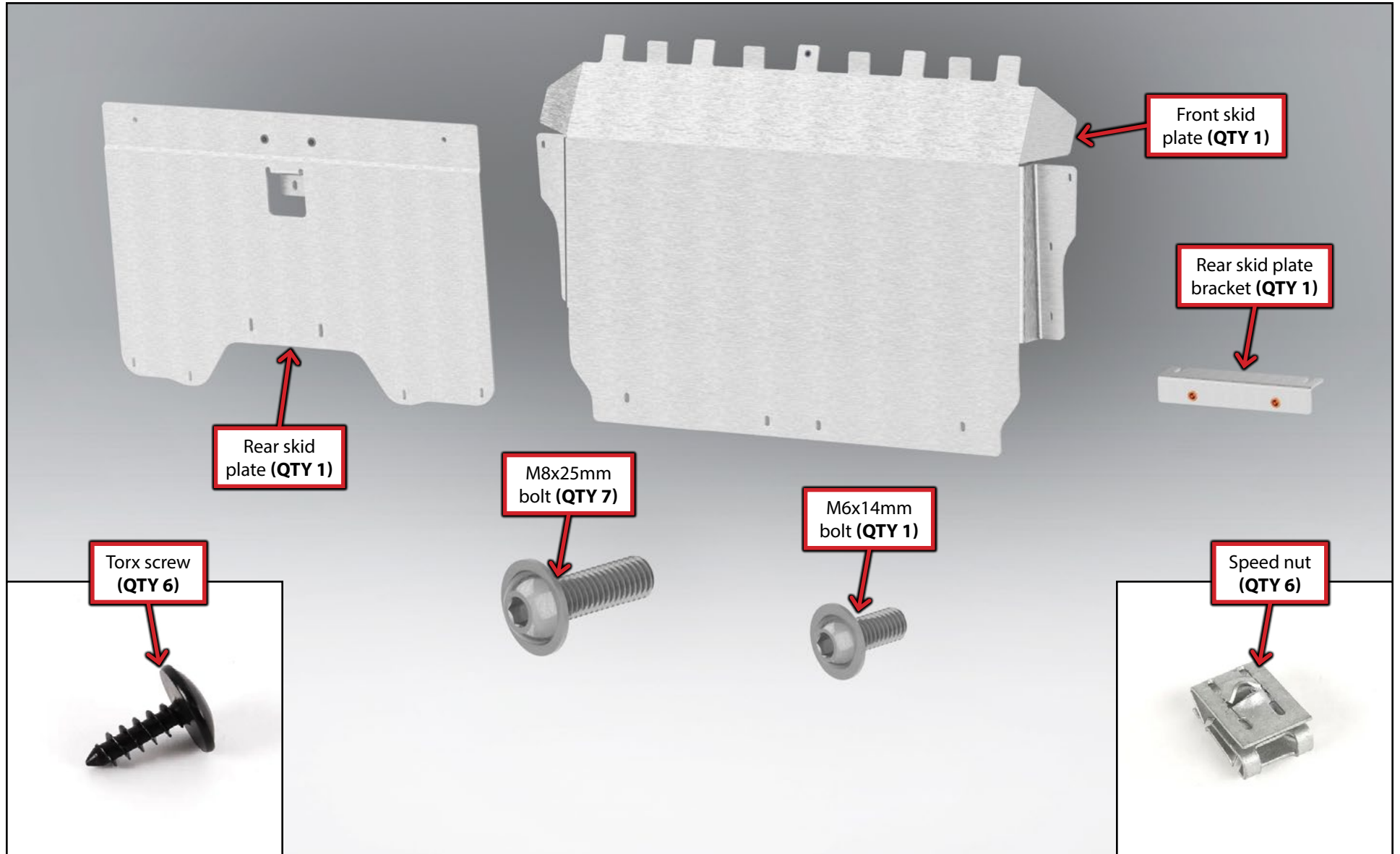

INSTALLATION NOTES

- **RH** refers to the *passenger side* of the vehicle.
- **LH** refers to the *driver side* of the vehicle.
- Always use the proper torque specifications.
- If applicable to this installation, torque specifications will be listed throughout the document and at the end as well.
- Please read all of these instructions and familiarize yourself with the complete process **BEFORE** you begin.

GENERAL PREPARATION AND SAFETY INFORMATION

ECS Tuning cares about your health and safety, please read the following safety information. This information pertains to automotive service in general, and while it may not pertain to every job you do, please remember and share these important safety tips.

- Park your car in a safe, well lit, level area.
- Shut the engine off and remove the key from the ignition switch.
- Make sure any remote start devices are properly disabled.
- **ALWAYS** wear safety glasses.
- Make sure the parking brake is applied until the vehicle is safely lifted and supported.
- If using an automotive lift, be sure and utilize the factory specified lift points.
- Lifting a vehicle in an incorrect location can cause damage to the suspension/running gear.
- When lifting a vehicle using a jack, always utilize the factory specified lift points.
- Lifting a vehicle in an incorrect location can cause damage to the suspension/running gear.
- **ALWAYS** support the vehicle with jack stands.
- Always read and follow all safety information and warnings for the equipment you are using.



NEVER get underneath a vehicle that is supported only by a jack, and **ALWAYS** make sure that the vehicle is securely supported on jack stands.

REMOVING THE OEM INSULATION PANEL

Step 1:

Safely lift and support the vehicle. Remove all of the fasteners from the OEM insulation panel (reference **Photo #1** and the color guide below it). The frontmost screw can be tricky to reach (**GREEN** inset photo).

Depress the two locking tabs (arrows in **Photo #1**), then slide the insulation panel rearward and remove it from the vehicle.

Now is a good time to replace the fender liner speed nuts (circled in **BLUE** in **Photo #1**, shown in **Photo #2**).

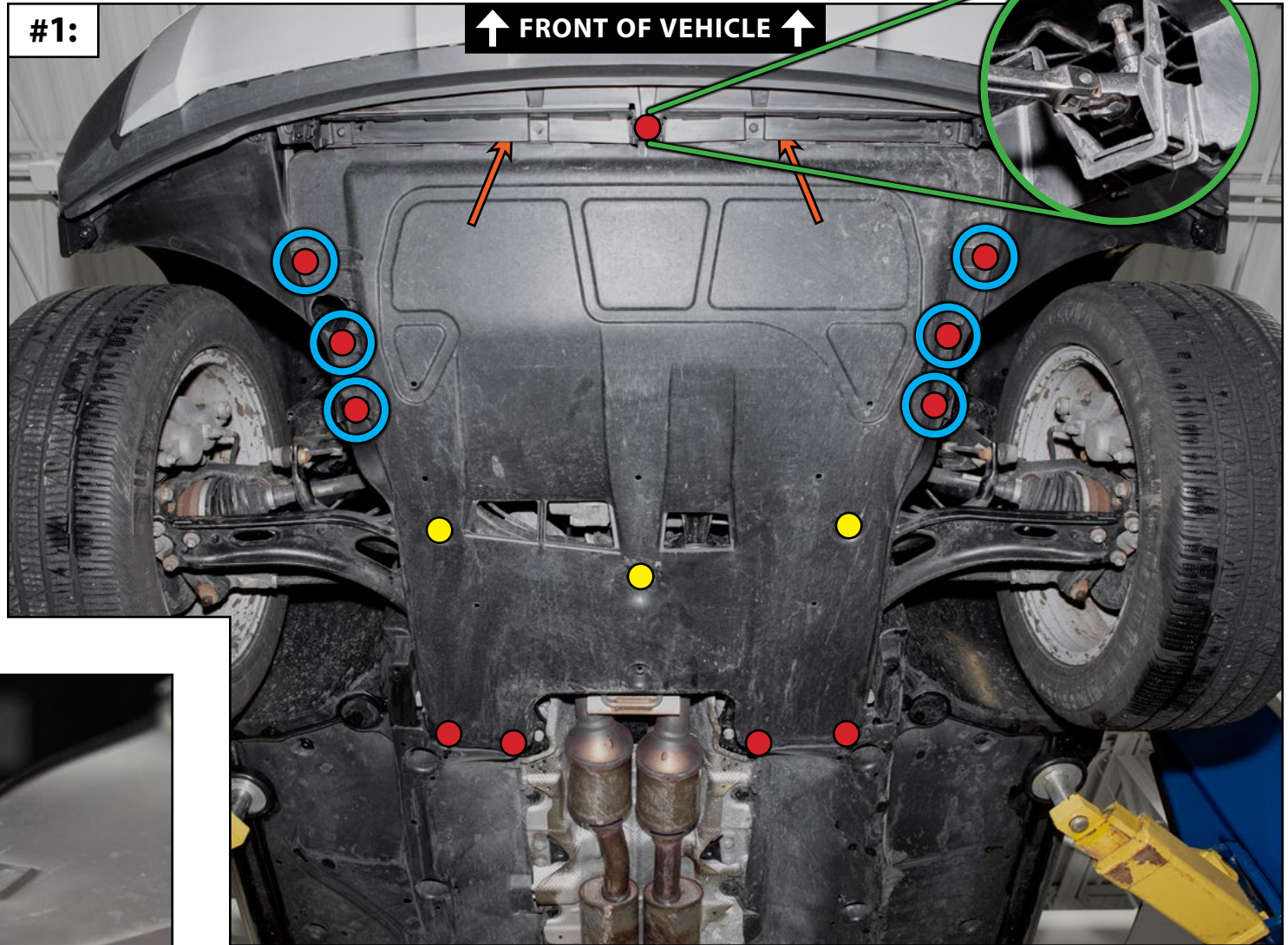

#1:

↑ FRONT OF VEHICLE ↑

#2:

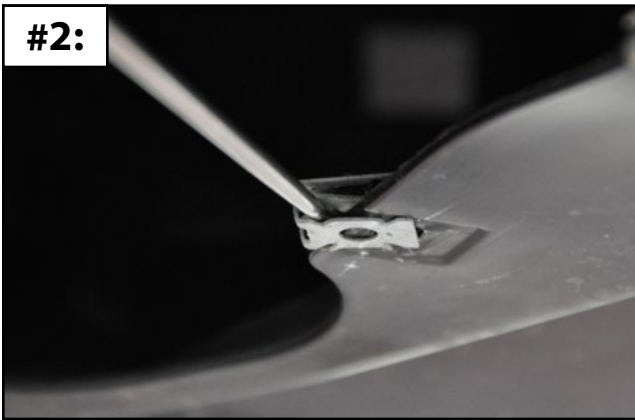

- T25 screws (QTY 7)
- T45 screws (QTY 3)

INSTALLING THE NEW STREET SHIELD SKID PLATE

Step 1: 13mm Socket & Ratchet

Loosen the two bolts securing the downpipe hanger to the subframe. There's no need to completely remove these bolts.

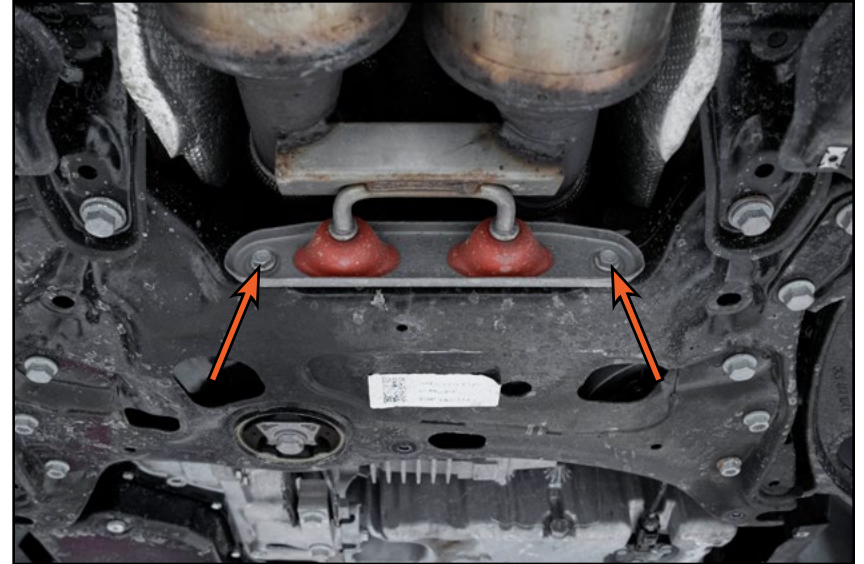

Step 2: 13mm Socket & Ratchet

Slide the tunnel brace bracket between the downpipe hanger and the subframe. Leave the bolts loose for now to allow for adjustment later on.

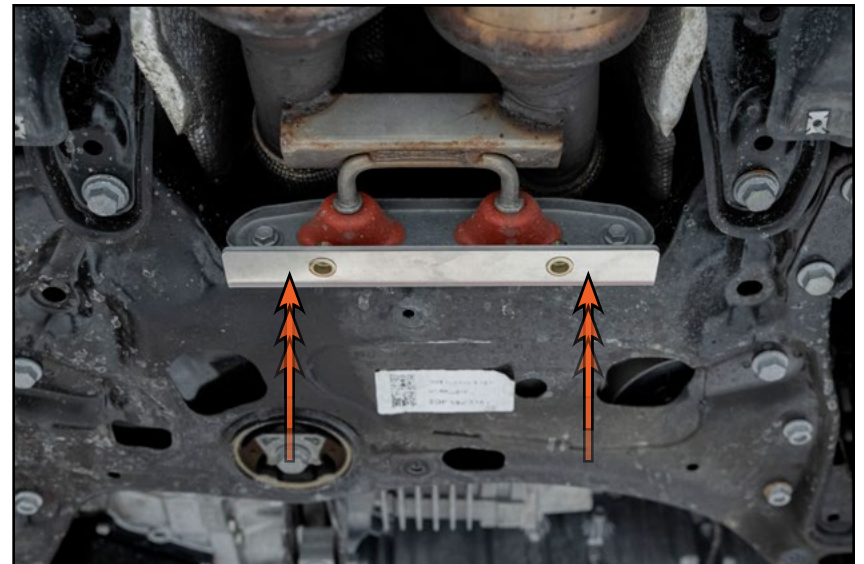

INSTALLING THE NEW STREET SHIELD SKID PLATE

Step 3:

Loosely install the rear skid plate into place, then loosely install the hardware using the photo on the right and the color guide below it as a reference.

The hardware needs to remain loose to allow you to adjust the plates for fitment on the next page.

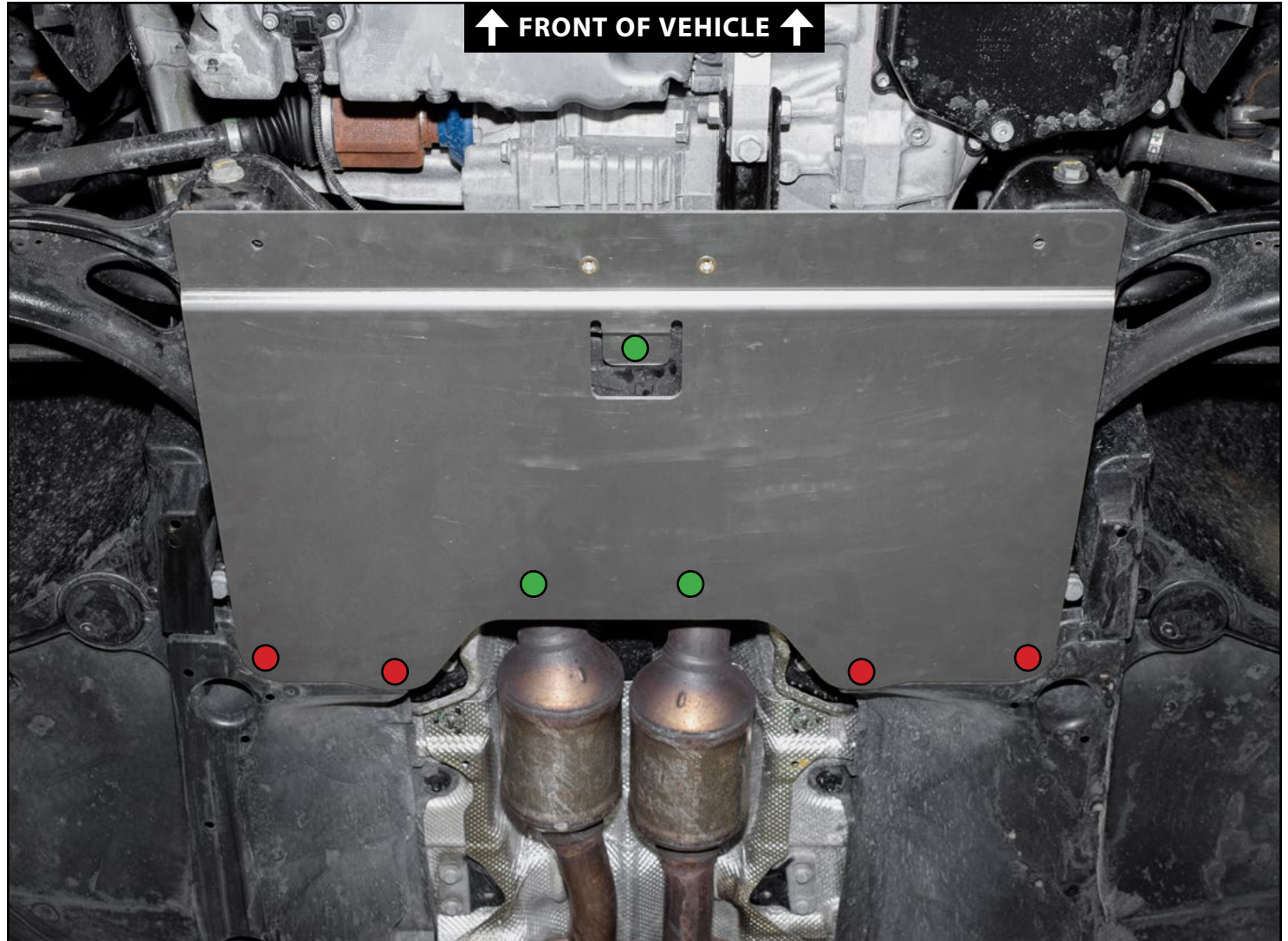

- T25 screws (QTY 4)
- M8x25mm bolts (QTY 3)

INSTALLING THE NEW STREET SHIELD SKID PLATE

Step 4:

Slide the front skid plate into place, making sure the tabs on the front edge fit into the lower core support.

Loosely install all remaining fasteners into the street shield using the photo on the right and the color guide below it as a reference.

Adjust the skid plates as needed, then hand tighten all of the fasteners. Torque the downpipe bracket bolts to 25 Nm (18 Ft-lbs).

Your installation is complete!

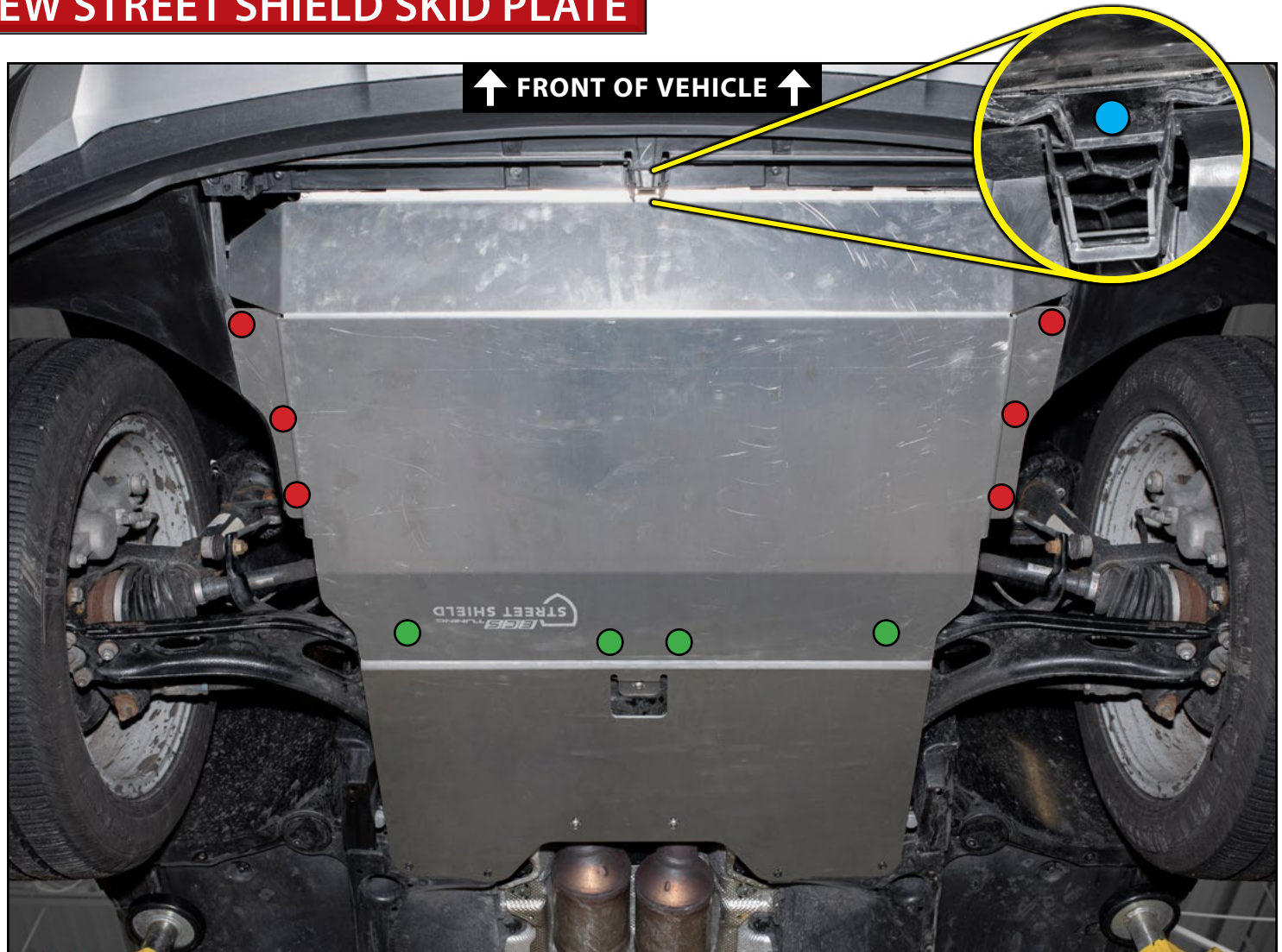

- T25 screws (QTY 4)
- M8x25mm bolts (QTY 4)
- M6x14mm bolt (QTY 1)

Your Street Shield Skid Plate installation is complete!



These instructions are provided as a courtesy by ECS Tuning

Proper service and repair procedures are vital to the safe, reliable operation of all motor vehicles as well as the personal safety of those performing the repairs. Standard safety procedures and precautions (including use of safety goggles and proper tools and equipment) should be followed at all times to eliminate the possibility of personal injury or improper service which could damage the vehicle or compromise its safety.

Although this material has been prepared with the intent to provide reliable information, no warranty (express or implied) is made as to its accuracy or completeness. Neither is any liability assumed for loss or damage resulting from reliance on this material. SPECIFICALLY, NO WARRANTY OF MERCHANTABILITY, FITNESS FOR A PARTICULAR PURPOSE OR ANY OTHER WARRANTY IS MADE OR TO BE IMPLIED WITH RESPECT TO THIS MATERIAL. In no event will ECS Tuning, Incorporated or its affiliates be liable for any damages, direct or indirect, consequential or compensatory, arising out of the use of this material.