



## VW/Audi 2014+ 1.8T/2.0T Billet Oil Filter Housing Installation Instructions - [Click HERE to Shop](#)



**Skill Level 1 - Easy**

**Basic Skills  
Required**



Proper service and repair procedures are vital to the safe, reliable operation of all motor vehicles as well as the personal safety of those performing the repairs. Standard safety procedures and precautions (including use of safety goggles and proper tools and equipment) should be followed at all times to eliminate the possibility of personal injury or improper service which could damage the vehicle or compromise its safety.

## INTRODUCTION

### “Brilliantly Billet”

Forget about your fragile, dull plastic oil filter housing. Forget about cracked housings or stripped heads. The ECS Tuning billet aluminum oil filter housing is an attractive, durable upgrade, machined from a solid block of T6 6061 aluminum to exact OEM specifications down to the original factory size hex nut. Choose your finish in polished, silver anodized or black anodized. Each housing is etched with the factory torque specification for quick reference whenever you’re changing the oil.



Black Anodized - [ES2785483](#)



Silver Anodized - [ES2785481](#)



Polished - [ES2785482](#)

## TABLE OF CONTENTS

Installation and Safety Information .....	<a href="#">pg.3</a>
Project Notes.....	<a href="#">pg.4</a>
Removing the Factory Oil Filter Housing .....	<a href="#">pg.5</a>
Installing the New Billet Oil Filter Housing .....	<a href="#">pg.7</a>
Bypass Valve Reassembly .....	<a href="#">pg.10</a>

## INSTALLATION NOTES

- **RH** refers to the *passenger side* of the vehicle.
- **LH** refers to the *driver side* of the vehicle.
- Always use the proper torque specifications.
- If applicable to this installation, torque specifications will be listed throughout the document and at the end as well.
- Please read all of these instructions and familiarize yourself with the complete process **BEFORE** you begin.

## GENERAL PREPARATION AND SAFETY INFORMATION

ECS Tuning cares about your health and safety, please read the following safety information. This information pertains to automotive service in general, and while it may not pertain to every job you do, please remember and share these important safety tips.

- Park your car in a safe, well lit, level area.
- Shut the engine off and remove the key from the ignition switch.
- Make sure any remote start devices are properly disabled.
- **ALWAYS** wear safety glasses.
- Make sure the parking brake is applied until the vehicle is safely lifted and supported.
- Whether lifting a vehicle using an automotive lift or a hydraulic jack, be sure and utilize the factory specified lift points.
- Lifting a vehicle in an incorrect location can cause damage to the suspension/running gear.
- **ALWAYS** support the vehicle with jack stands.
- **ALWAYS** read and follow all safety information and warnings for the equipment you are using.



**NEVER** get underneath a vehicle that is supported only by a jack, and **ALWAYS** make sure that the vehicle is securely supported on jack stands.

## PROJECT NOTES

Before we begin we'd like to help identify which oil filter housing you might have installed on your engine. Our billet housing fits all revisions, but there are some important details you should know before you begin.

Note the differences between the older and newer revision filter housings in the two illustrations on the right.

No matter which revision you have, you **MUST** swap the filter support over to the new billet housing because of the built in check valve.

An older revision filter support **IS NOT** compatible with a newer revision adapter valve. If your older revision adapter valve has broken you'll need to also purchase a newer revision filter housing to acquire the revised filter support.

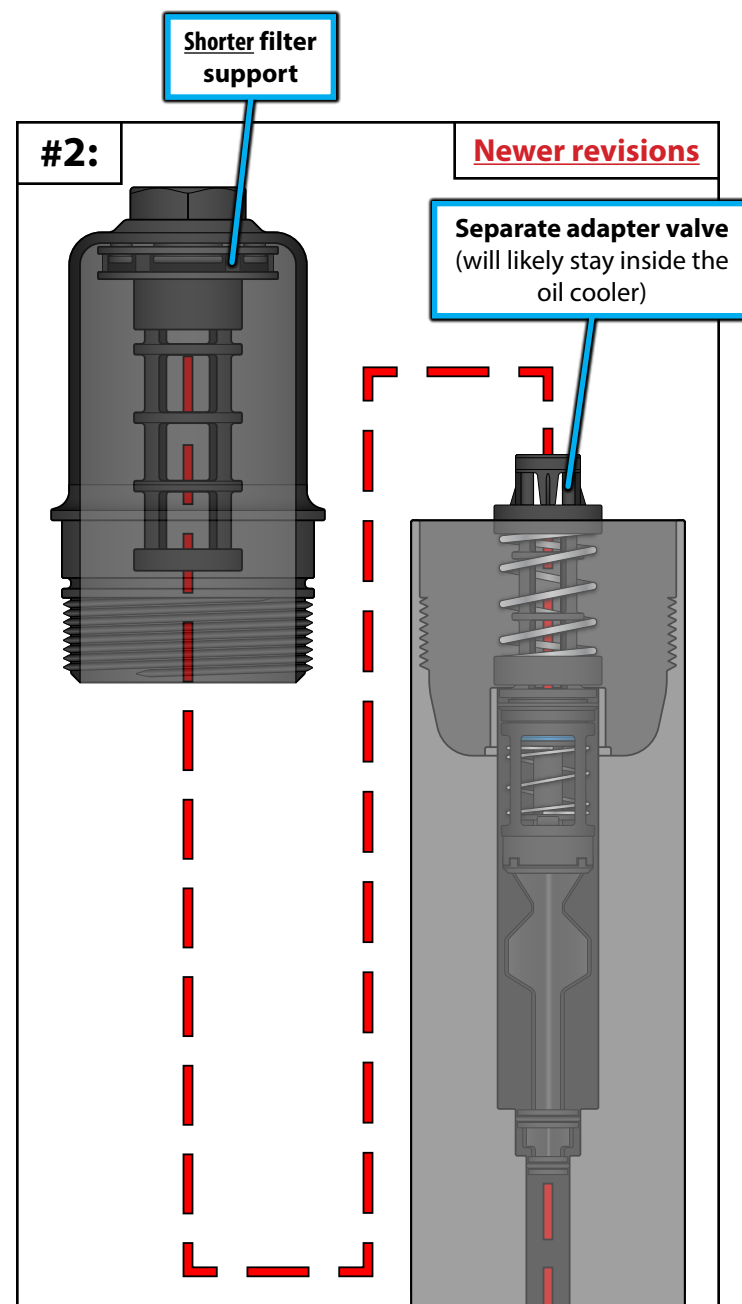
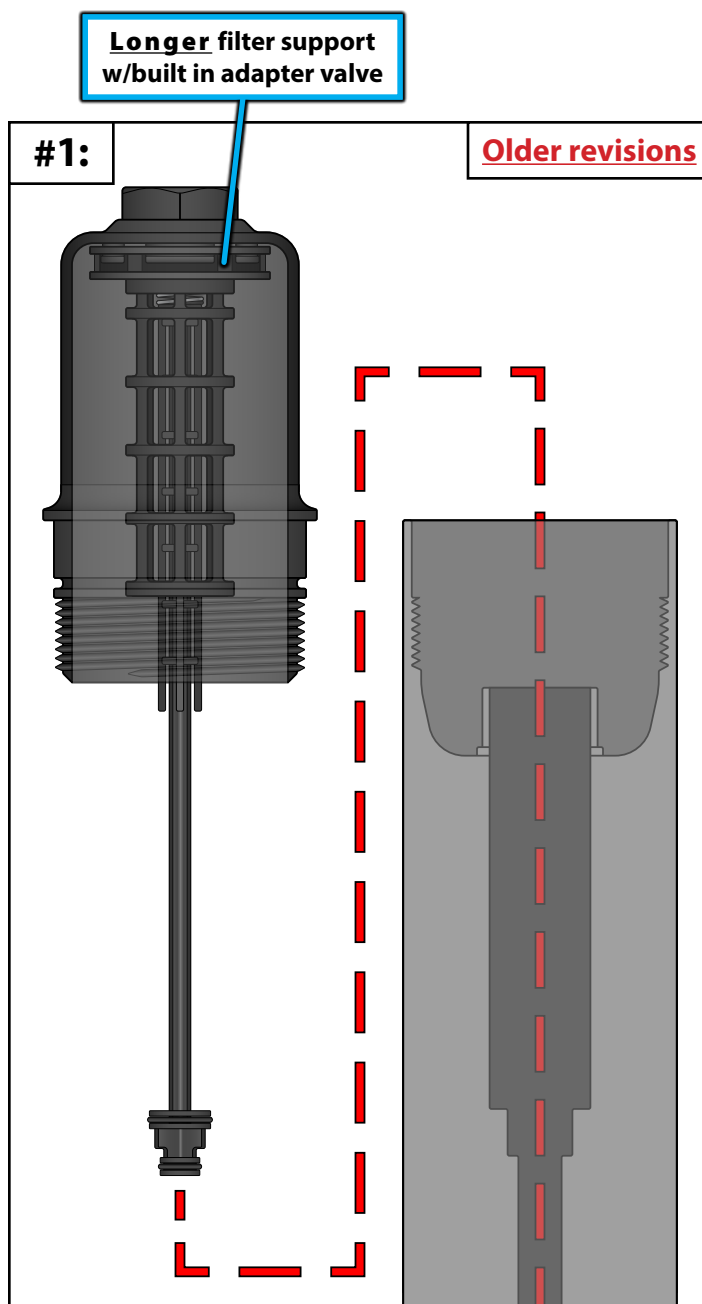



## REMOVING THE FACTORY OIL FILTER HOUSING

### Step 1:

Pull up on the engine cover on both sides to release the rubber grommets that hold it in place. Pull upwards on the left side of the cover and remove it from the vehicle (**photo #1**).

Loosen and remove the factory oil filter housing using a 32mm socket & ratchet (**photo #2**).

Clean any oil from the housing and the area around the filter that may have spilled out during removal (**photo #3**).

Remove the oil filter from the engine (**photo #4**).

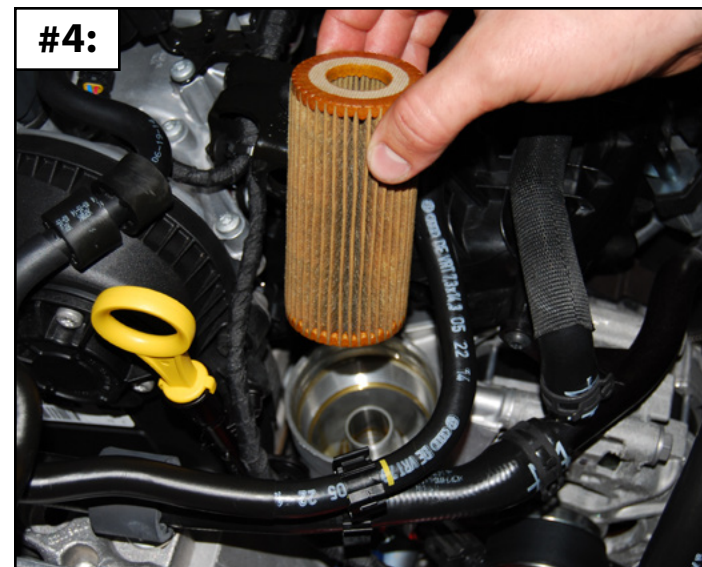
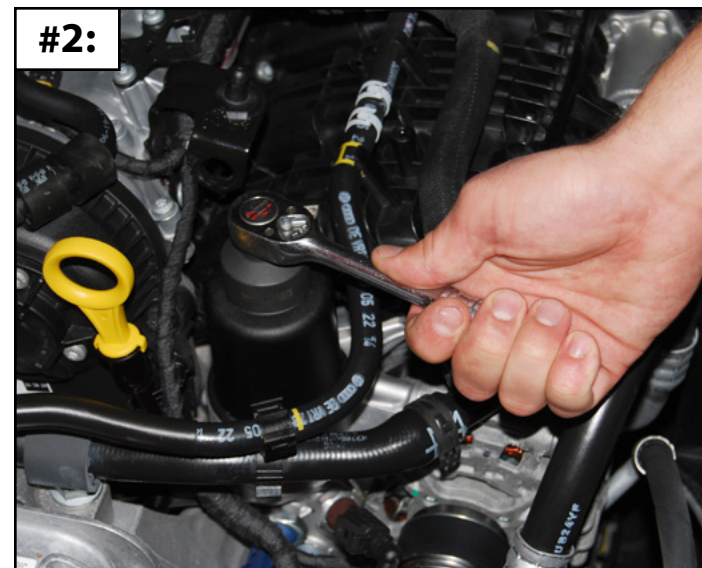
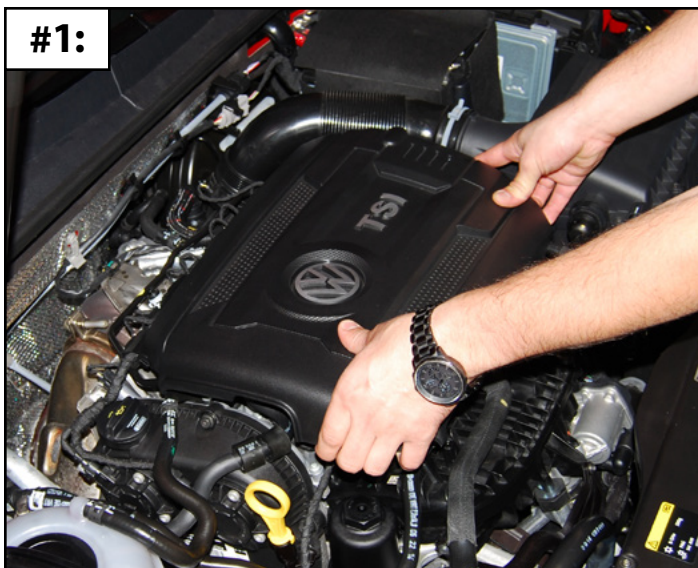

## REMOVING THE FACTORY OIL FILTER HOUSING

### Step 2:

The original oil filter housing utilizes a filter support with an integrated spring-loaded bypass valve, which needs to be transferred to the new billet oil filter housing. To remove this assembly, pull it firmly to one side as shown in the picture, and move it back and forth until it releases from the securing tabs at the bottom of the housing.



**CAUTION:** Do not pull on the long guide rod which extends from the filter support.



### Step 3:

Once the assembly has been released, pull it out of the filter housing.



If the bypass valve becomes separated from the filter support, click [HERE](#) for reassembly instructions.





## INSTALLING THE NEW BILLET OIL FILTER HOUSING

### Step 1:

Lubricate the new housing o-ring with clean motor oil (replacement seals are included with new oil filters).



### Step 2:

Install the o-ring into the groove in the new billet housing, as shown. Be sure the o-ring is completely seated in the groove all the way around the housing.



## INSTALLING THE NEW BILLET OIL FILTER HOUSING

### Step 3:

Align the circular groove at the base of the filter support with the securing tabs at the base of the filter housing.

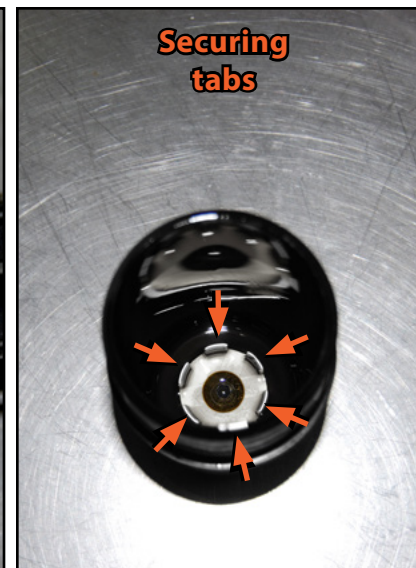
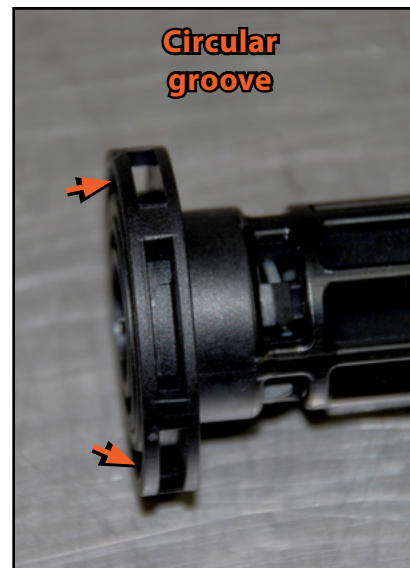

### Step 4:

Press the filter support firmly into the housing until it is fully seated. This is a press fit and you will feel it "bottom out", rather than snap into place.





## INSTALLING THE NEW BILLET OIL FILTER HOUSING

### Step 5:

#### **NEW REVISION ADAPTER**

**VALVE ONLY:** Install the adapter valve into the oil cooler (not shown).

Install the new oil filter into the engine (**photo #1**).

Install the new ECS billet aluminum housing into location, sliding the guide rod and filter support in through the filter (**photo #2**).

Thread the filter housing all the way in until it is fully seated, use caution to prevent cross threading the housing (**photo #3**).

Torque the oil filter housing (**photo #4**) to 24 Nm (18 ft-lbs).

Reinstall the engine cover. Check the engine oil level if you are not changing the oil at this time, a small amount of oil may have been lost during this installation.

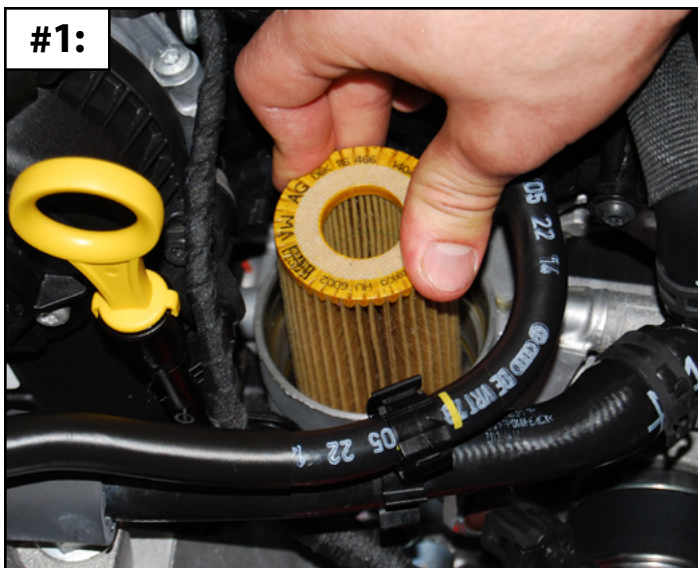



## BYPASS VALVE REASSEMBLY

### Step 1:

The bypass valve is attached to the filter support with four plastic tabs. If yours separates during the install it can easily be reassembled. Begin by arranging all of the parts in order as shown (**photo #1**).

Place the pintle onto the spring (**photo #2**).

Insert the spring and pintle into the valve seat as shown (**photo #3**).

Insert the valve seat, pintle and spring into the filter support, making sure the spring is aligned with the spring seat in the center. Then align the tabs with the open slots and push the valve seat into place (**photo #4**).

Once this is complete you can jump back to the installation steps on [Page 6](#).

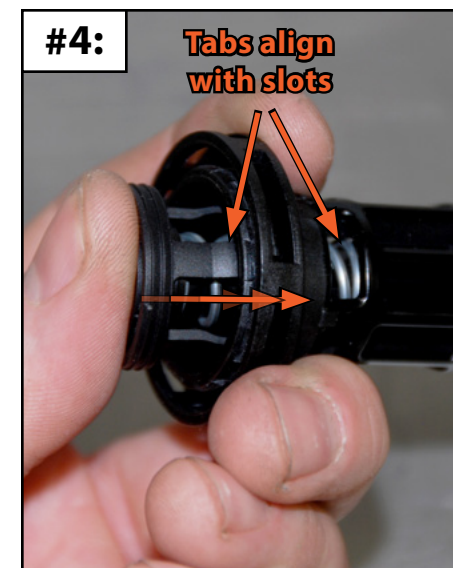
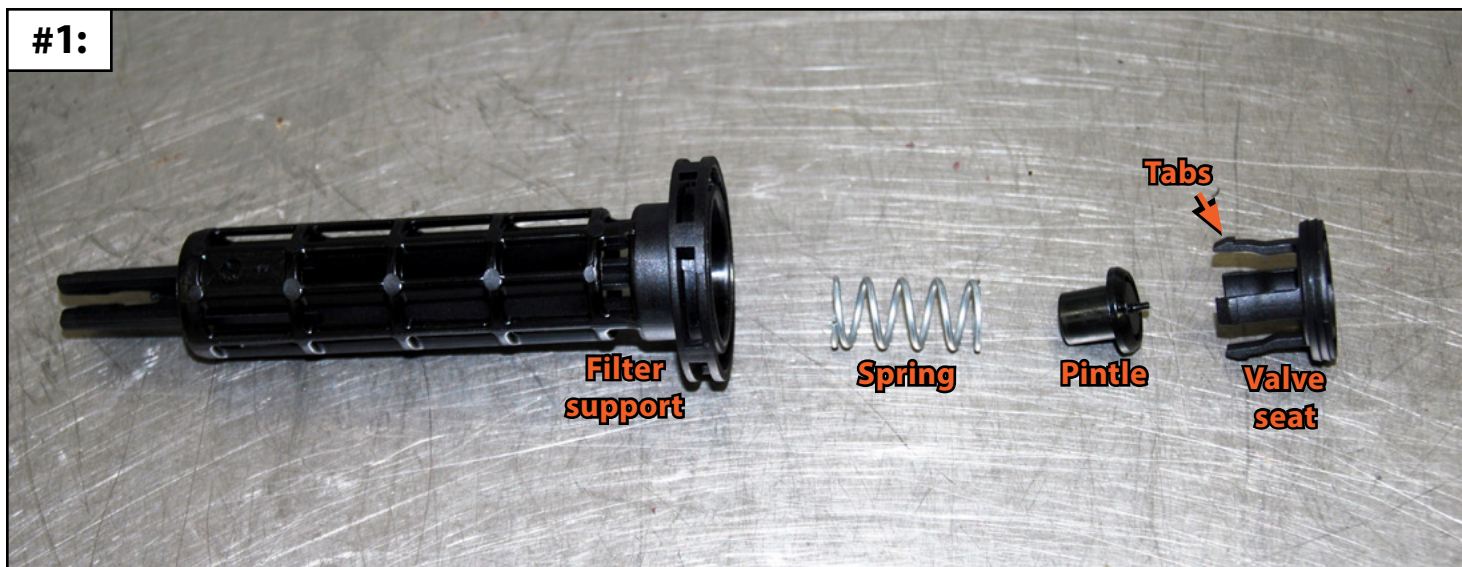

**Your ECS Tuning Billet Aluminum Oil Filter Housing installation is complete!**



**These instructions are provided as a courtesy by ECS Tuning**

Proper service and repair procedures are vital to the safe, reliable operation of all motor vehicles as well as the personal safety of those performing the repairs. Standard safety procedures and precautions (including use of safety goggles and proper tools and equipment) should be followed at all times to eliminate the possibility of personal injury or improper service which could damage the vehicle or compromise its safety.

Although this material has been prepared with the intent to provide reliable information, no warranty (express or implied) is made as to its accuracy or completeness. Neither is any liability assumed for loss or damage resulting from reliance on this material. SPECIFICALLY, NO WARRANTY OF MERCHANTABILITY, FITNESS FOR A PARTICULAR PURPOSE OR ANY OTHER WARRANTY IS MADE OR TO BE IMPLIED WITH RESPECT TO THIS MATERIAL. In no event will ECS Tuning, Incorporated or its affiliates be liable for any damages, direct or indirect, consequential or compensatory, arising out of the use of this material.