



P3CARS.COM
PRECISION • PASSION • PERFORMANCE

Please download the latest copy of this document from www.p3cars.com/install

BMW 135 / 1M Basic Installation



1 With the driver's door open, pull off the rubber door seal, it is just a friction fit. Now we have access to the edge of the dash and kick panels.



2 Remove the side dash cover as shown. It is easiest to start at the bottom of the panel first.

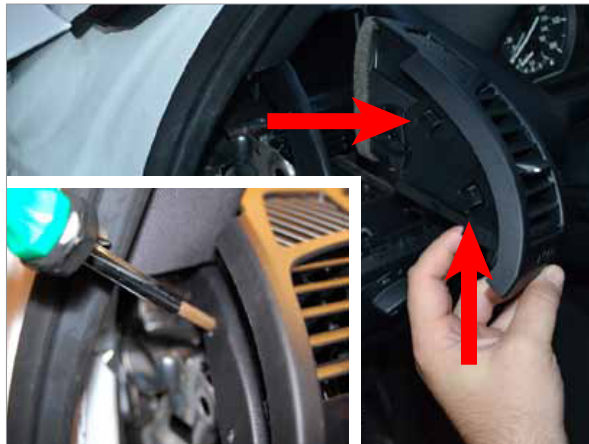

3 There are 2 SQUARE holes in the dash left of the vent, these holes allow you to press the vent's tabs through the holes to release the vent from the dash.



4 Remove the light switch panel by removing two #20 torx screws at the top, and one at the bottom as shown.

WARRANTY & LIABILITY:

Neither P3 Cars, nor its dealers or agents shall be liable in any way, for any damage, loss, injury or other claims, resulting from the installation or use of this product. By purchasing or installing this product, you assume all liability of any kind connected with the use and/or application of this product. If you are unsure that you can safely install and use this product, consult a qualified installer or mechanic. The warranty on this product covers only the product itself for a period of 6 months from the date of purchase, and it will be at our discretion to repair or replace the affected parts. No user serviceable parts inside. Warranty will be voided if product shows physical damage.



5 If you ordered a model pre-installed into the vent, then you are ready to install into the car. If you did not purchase the gauge pre-installed, assemble the vent gauge into the vent. Download vent install instructions from www.p3cars.com/install/bmw

FOR N54 CARS (2007-2010), and 1M, or BOOSTED e90/e92 M3 INSTALL BOOST LINE TAP.

If you have a car with n54 engine, you will need to install the included plug and play boost line tap to get a proper manifold boost reading into the gauge.

Please see the BOOST LINE TAP instruction PDF and Video at www.p3cars.com/install/bmw



P3CARS.COM
PRECISION • PASSION • PERFORMANCE

Please download the latest copy of this document from www.p3cars.com/install



6 Remove the lower dash cover below the steering wheel by removing the three #20 torx screws shown here. Lay this cover down into the footwell.



7 Remove the side kick panel cover screws, first remove the Phillips screw holding the hood pop lever, then the screw behind the lever. 2 screws total.



8 Flex this panel forward to get access to the OBD2 port and the trunk pop switch. You will need to pull the rubber door seal forward to free the panel.



9 Feed the display wire down to the lower dash footwell area and connect it to the control box.

WARRANTY & LIABILITY:
Neither P3 Cars, nor its dealers or agents shall be liable in any way, for any damage, loss, injury or other claims, resulting from the installation or use of this product. By purchasing or installing this product, you assume all liability of any kind connected with the use and/or application of this product. If you are unsure that you can safely install and use this product, consult a qualified installer or mechanic. The warranty on this product covers only the product itself for a period of 6 months from the date of purchase, and it will be at our discretion to repair or replace the affected parts. No user serviceable parts inside. Warranty will be voided if product shows physical damage.

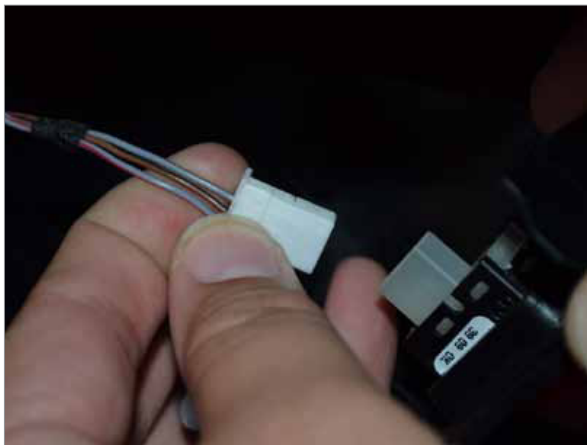

10 (Optional) To use the auto dimmer, D.On.A function of the gauge, connect the GREEN harness wire to the Red/Gray wire on the TRUNK POP SWITCH with the T-Tap connector. If you do not tap this wire for dimmer, you can use the one-touch manual dimmer option on the gauge.

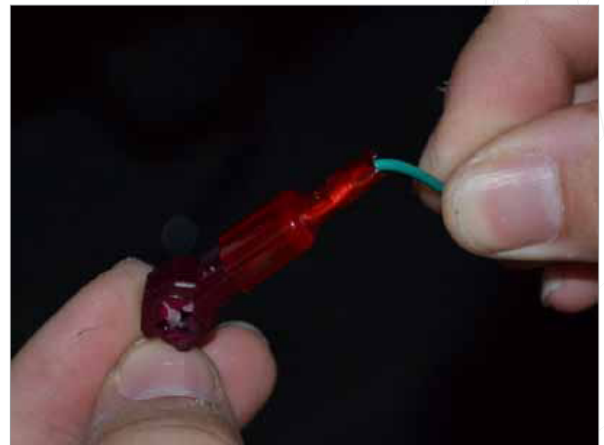



P3CARS.COM
PRECISION • PASSION • PERFORMANCE

Please download the latest copy of this document from www.p3cars.com/install



11 Plug in the obd2 connector to the car.



12 Connect the vacuum line and harness to the control box as shown. (note: for versions earlier than 2.1, the vacuum port is on the harness)



13 Start the engine and make sure the gauge turns on now that everything is hooked up properly, then fully re-install the vent and surrounding panels/trim.



14 Replace the side kick panel and tuck/secure the control box and harness up above this panel near the other factory wiring.

WARRANTY & LIABILITY:
Neither P3 Cars, nor its dealers or agents shall be liable in any way, for any damage, loss, injury or other claims, resulting from the installation or use of this product. By purchasing or installing this product, you assume all liability of any kind connected with the use and/or application of this product. If you are unsure that you can safely install and use this product, consult a qualified installer or mechanic. The warranty on this product covers only the product itself for a period of 6 months from the date of purchase, and it will be at our discretion to repair or replace the affected parts. No user serviceable parts inside. Warranty will be voided if product shows physical damage.



15 Replace the hood pop lever and then replace the footwell cover below the steering wheel.

You're Done!

See the config directions at www.p3cars.com/install

Please be sure to SELECT YOUR ENGINE TYPE as well as CALIBRATE the analog sensor.

Enjoy your new gauge!